

Windows and balcony doors - STYLE 68 ALU

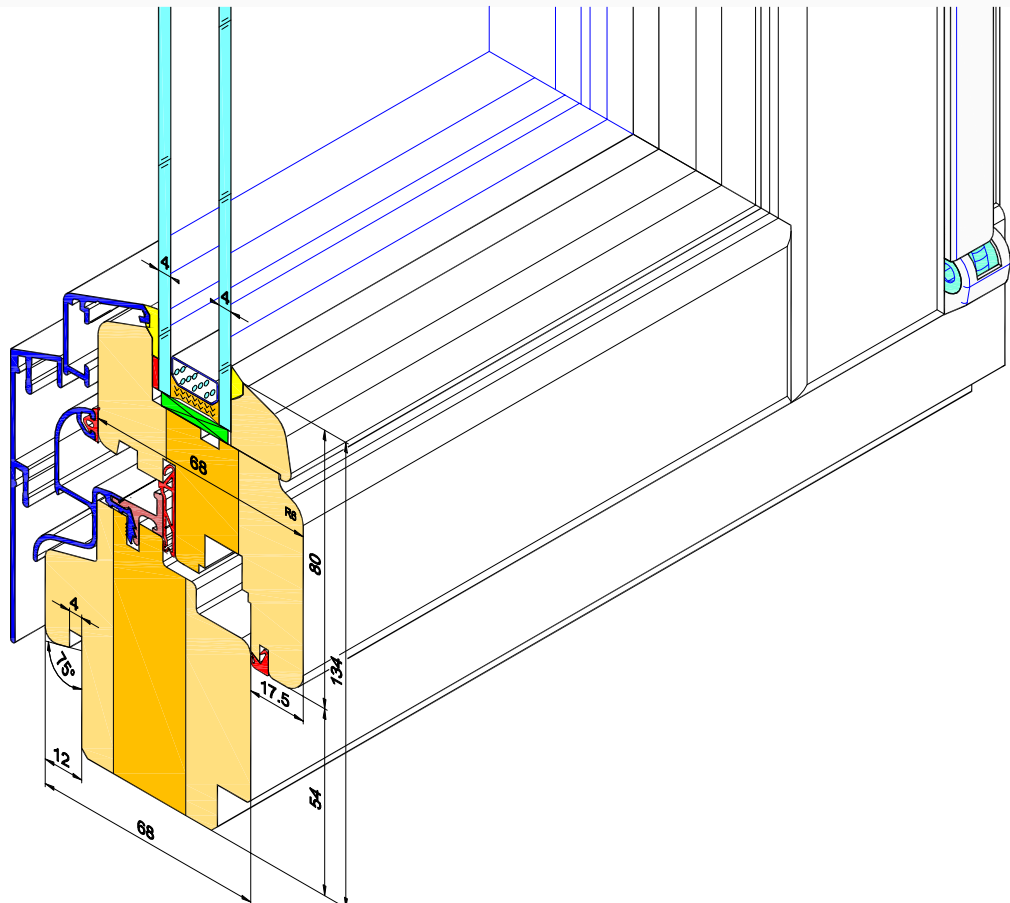

	<i>technical issue</i>	<i>description</i>	<i>notes</i>
1	CONSTRUCTION	STYLE 68 ALU	
2	MATERIAL	<ul style="list-style-type: none"> <li>- pine fingerjointed,</li> <li>- pine sorted (not fingerjointed),</li> <li>- meranti,</li> </ul>	
3	FITTINGS OPTIONS	<p>Obwiedniowe,</p> <ul style="list-style-type: none"> <li>- tilt, turn, turn&amp;tilt, tilt&amp;turn,</li> <li>- flying mullion with espagnolette,</li> <li>- tilt with HAU-TAU opener (from floor level),</li> <li>- anti-burglar options: RC1, RC2,</li> <li>- tilt and slide,</li> <li>- balcony doors with low aluminium threshold,</li> <li>- hidden hinges,</li> <li>- TBT handle function (tilt before turn),</li> </ul>	
4	WINDOW SHAPE	<ul style="list-style-type: none"> <li>- rectangle,</li> <li>- triangle,</li> <li>- trapezium,</li> </ul>	
5	SIZE RANGES	<p>Sash width</p> <ul style="list-style-type: none"> <li>- standard: 332 - 1547mm,</li> <li>- RC1: 396 - 1761mm,</li> <li>- RC2: 396 - 1511mm,</li> </ul> <p>Sash height</p> <ul style="list-style-type: none"> <li>- max 2600mm,</li> </ul> <p>Note: proportion of sash width to sash height - 1.5            Max sash weight 130kg - (tilt, tilt&amp;turn).            Max sash weight 50kg - (turn).            Max sash weight 80kg - (triangle)</p> <p>Weight of 1m<sup>2</sup> of glass (1mm thickness) - 2.5kg</p>	
6	GLAZING UNITS	- glazing unit thickness max 31mm - rectangle, trapezium, triangle shapes	
7	TIMBER FINISH	Final painting with water-based opaque paints or stains	
8	COLOUR	<ul style="list-style-type: none"> <li>- opaque: RAL 9016 (white),</li> <li>- Stain: Pine TM367, Afromozja TM4239, Mahogany TM1530, Palisander TM1705, Teak TM1703, Cyprys TM5207, Venge TM9012, Nut TM1515, Graphite TM1504,</li> <li>- pozostałe z palety RAL,</li> </ul>	
9	DRIP CAPS	Frame thermally broken drip cap, additional sash drip cap (standard) <ul style="list-style-type: none"> <li>- white, brown, olive</li> <li>- other colours from RAL palette at request,</li> </ul>	
10	COVERS	fittings: hinge covers: white, olive	
11	GLAZING BARS	<ul style="list-style-type: none"> <li>- construction (structural) bars 80mm,</li> <li>- vienna (glued-on) bars 12x24mm,</li> <li>- internal glazing bars (inside insulated glass unit),</li> </ul>	

	<i>technical issue</i>	<i>description</i>	<i>notes</i>
12	Widths of construction elements	<ul style="list-style-type: none"> <li>- Sash element width: 80mm,</li> <li>- Frame element width: 83mm,</li> </ul>	
13	VENTS	<p>in sash:</p> <ul style="list-style-type: none"> <li>a) Aereco EMM</li> <li>b) Trimvent 90 HL</li> <li>c) Aereco EXR</li> </ul> <p>Note: External vent hood fitted on frame head.</p> <p>in frame:</p> <ul style="list-style-type: none"> <li>a) Trimvent S13</li> <li>b) Aereco EMM</li> <li>c) Ventair</li> </ul>	
14	ADDITIONAL OPTIONS	<ul style="list-style-type: none"> <li>- frame widener,</li> <li>- frame connector,</li> <li>- 90 degree corner post,</li> <li>- 135 degree corner post,</li> <li>- counterprofile,</li> <li>- thresholds,               <ul style="list-style-type: none"> <li>a) Cutting 12x30 mm from outside and cutting 11x30mm from inside,</li> <li>b) Cutting 11x30mm from inside,</li> <li>c) Cutting 12x30 mm from outside,</li> <li>d) Cutting 12x30 mm from outside and cutting 11x14mm from inside,</li> <li>e) Cutting 12x30 mm from outside and groove 10x10mm from inside,</li> <li>f) without cutting,</li> </ul> </li> <li>- timber cover bead (45mm, 35mm),</li> </ul>	
15	SILICONE	<ul style="list-style-type: none"> <li>- transparent,</li> </ul>	

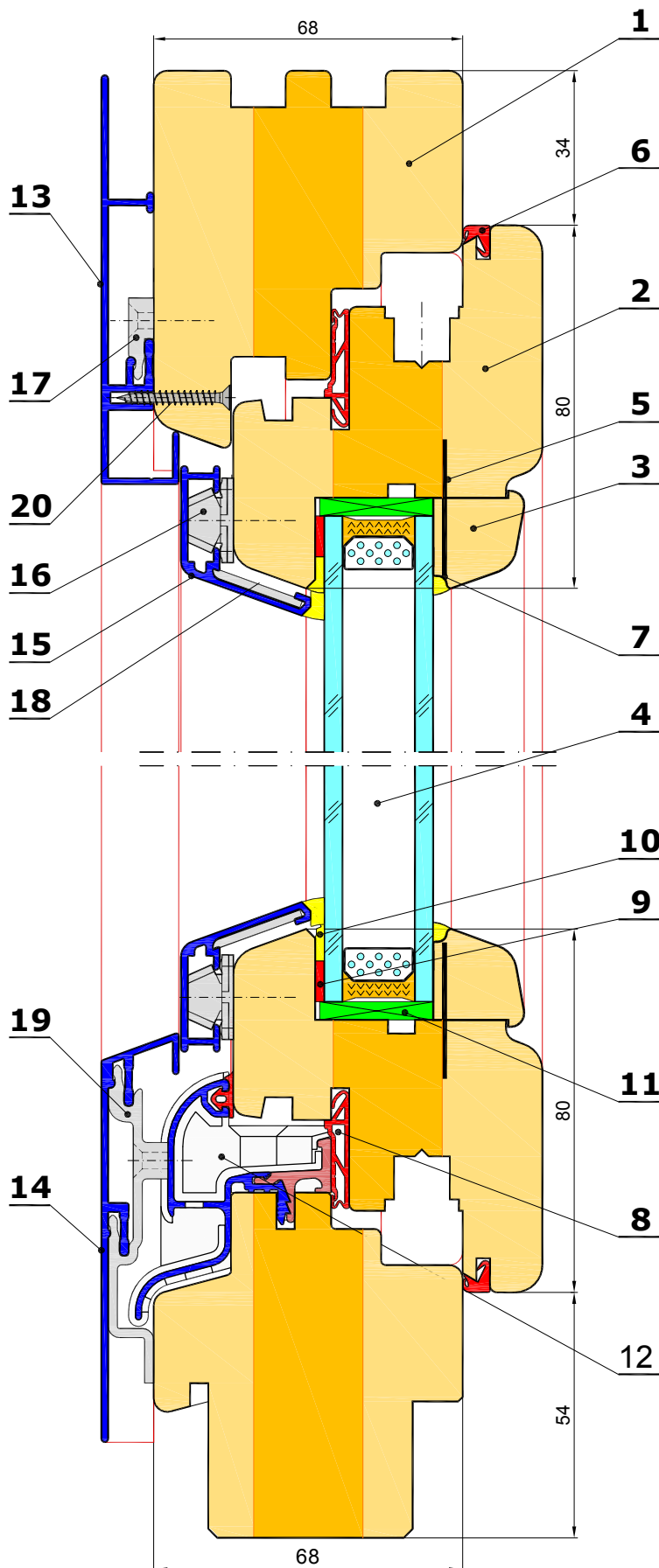

Zestawienie elementów

- 1 - window frame - timber
- 2 - window sash - timber
- 3 - glazing bead with groove for silicone
- 4 - insulated glass unit
- 5 - steel nail SK330 (1,1x30mm)
- 6 - edge gasket TPS - SP33 Deventer
- 7 - silicone according to DIN 1845 T.2 (group E)
- 8 - rebate gasket TPE - SV180 Deventer
- 9 - neoprene glazing gasket
- 10 - silicone according to DIN 1845 T.2 (group E)
- 11 - glazing PVC block - 3,5x25x100mm
- 12 - aluminium gutter drip
- 13 - aluminium frame profile
- 14 - bottom aluminium frame profile
- 15 - sash aluminium profile
- 16 - plastic installation clip
- 17 - frame catch
- 18 - stiffening plastic corner
- 19 - bottom frame catch
- 20 - countersunk stainless steel screw

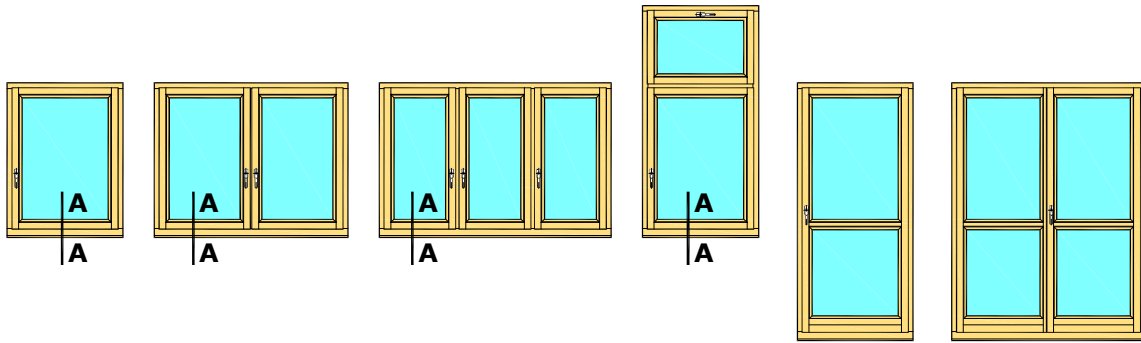

**A-A**

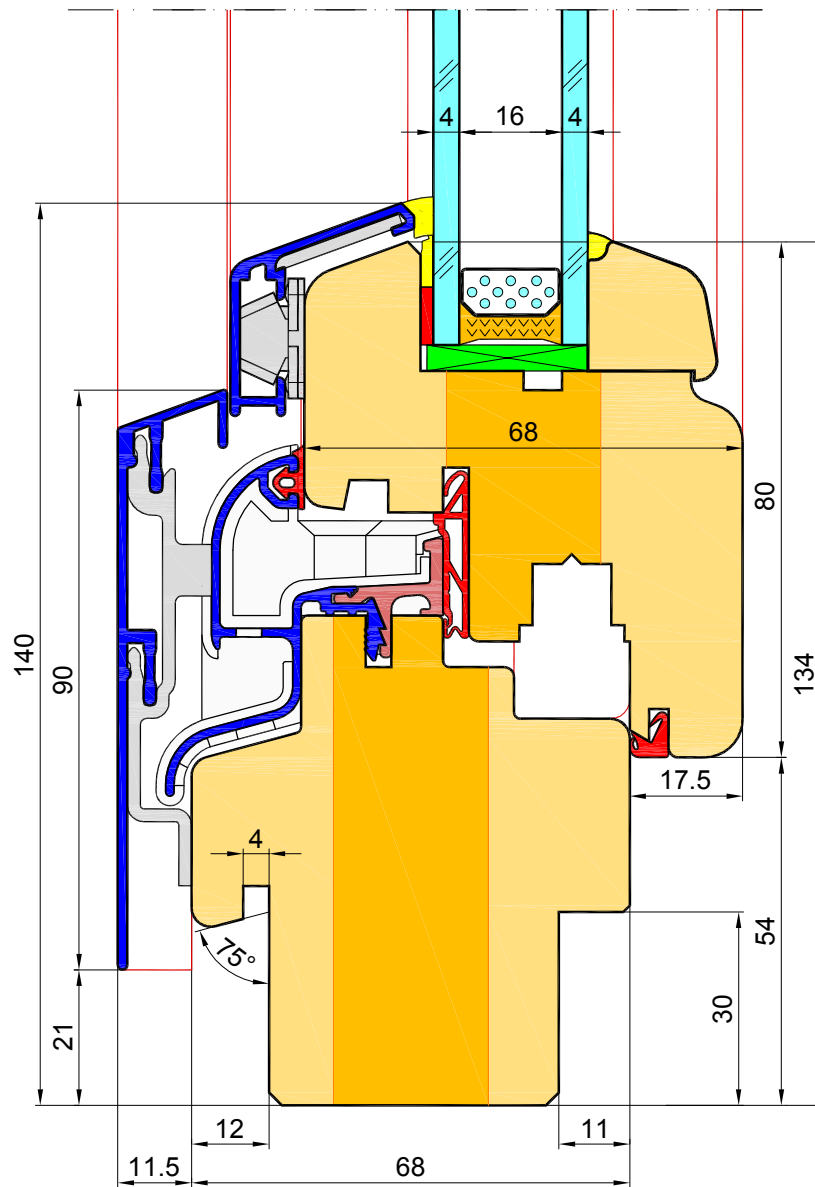

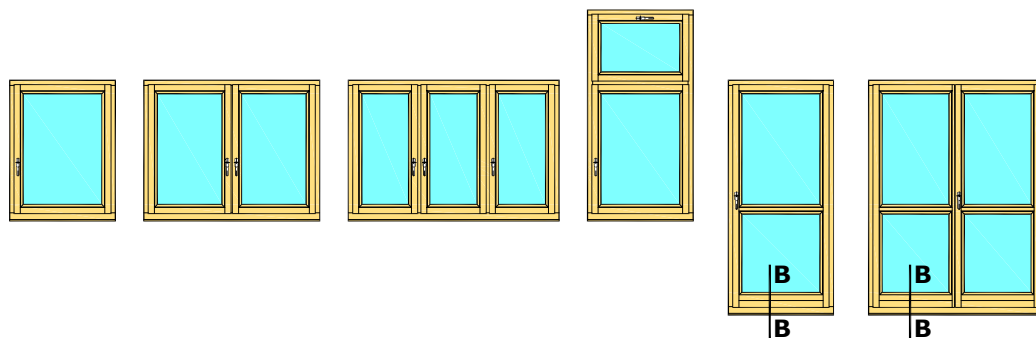

**B-B**

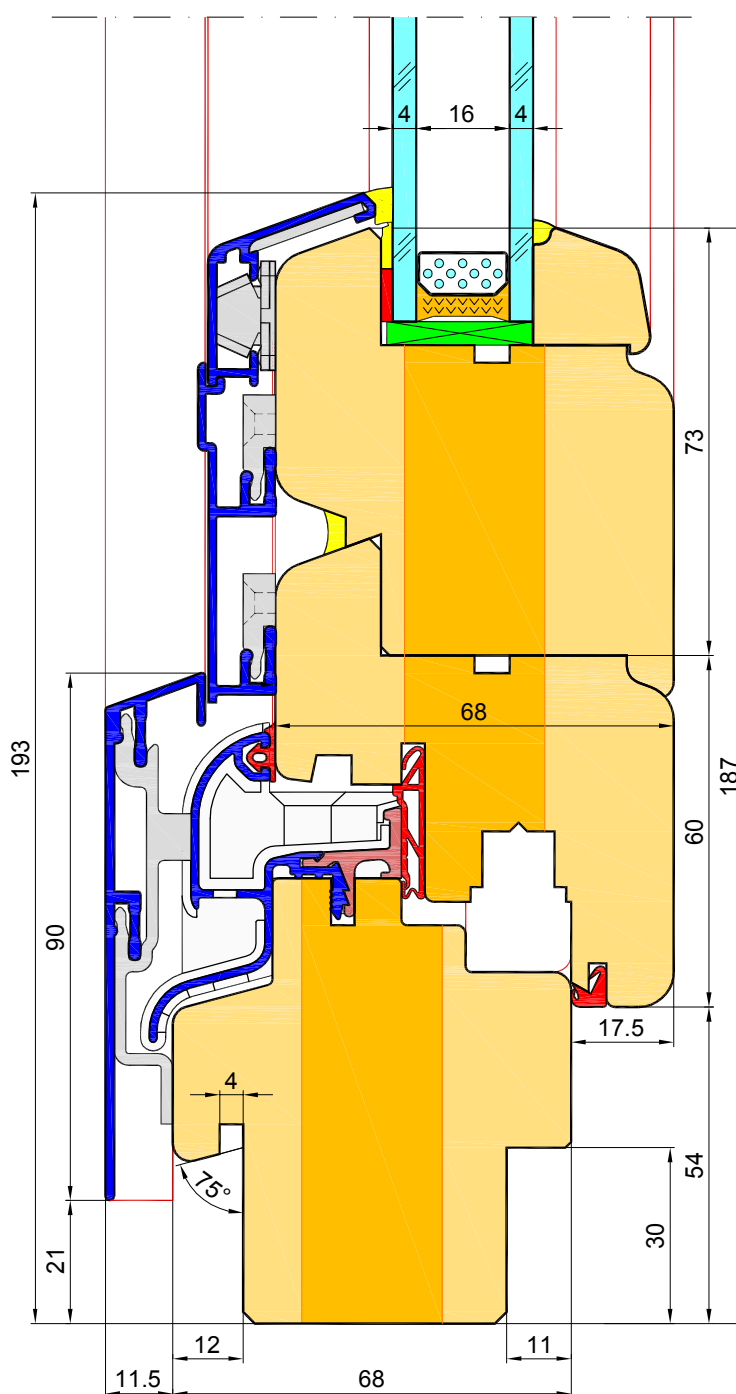

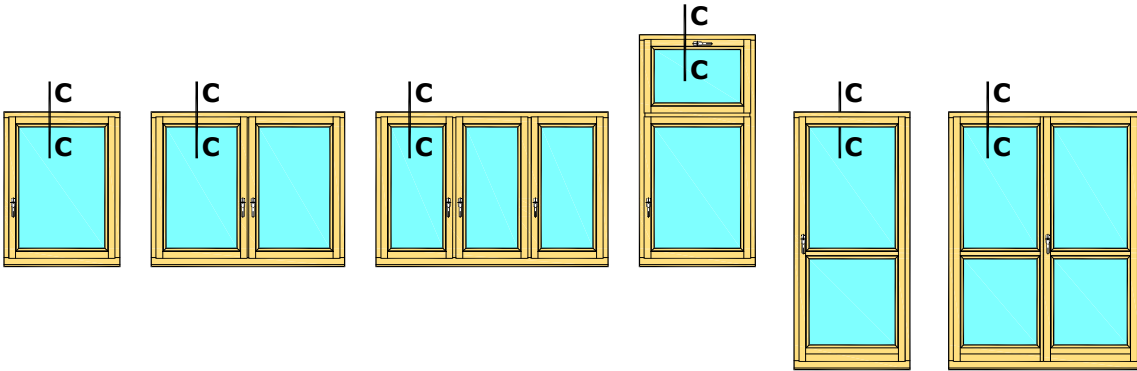

**C-C**

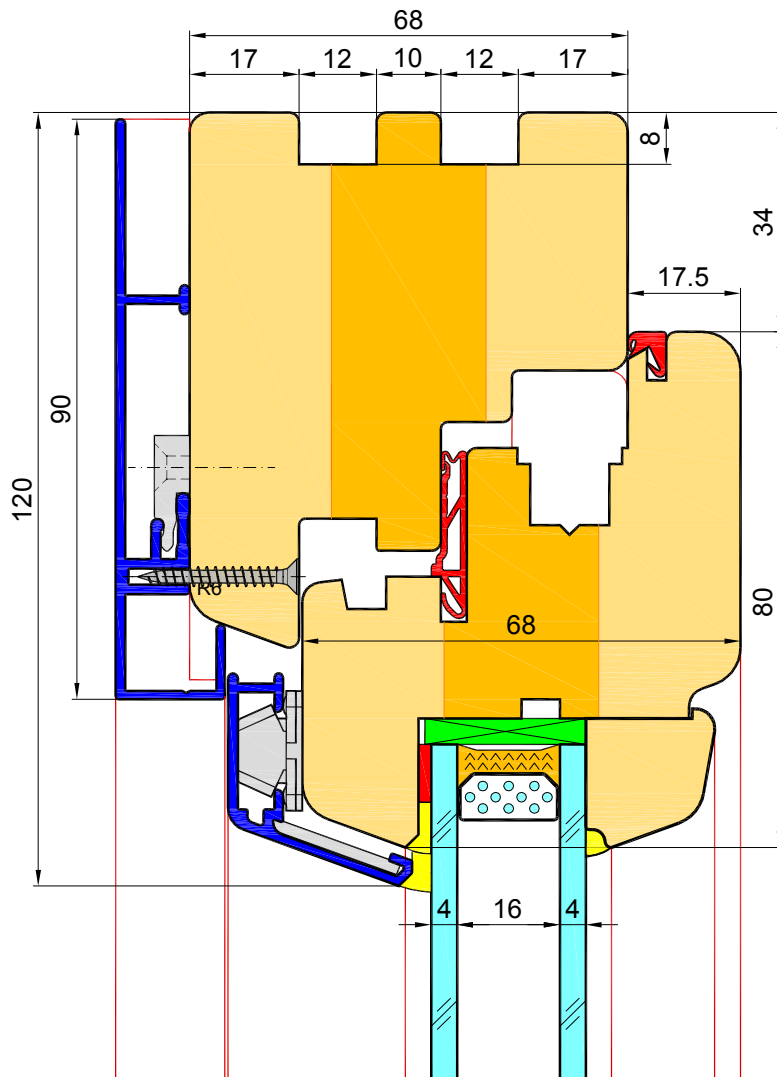

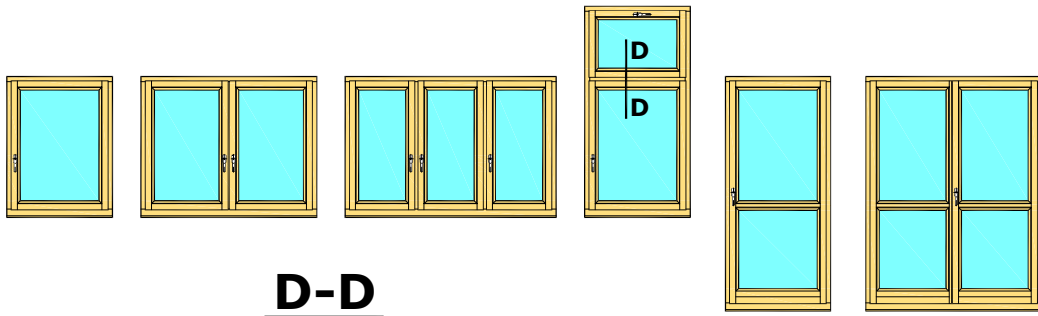

**D-D**

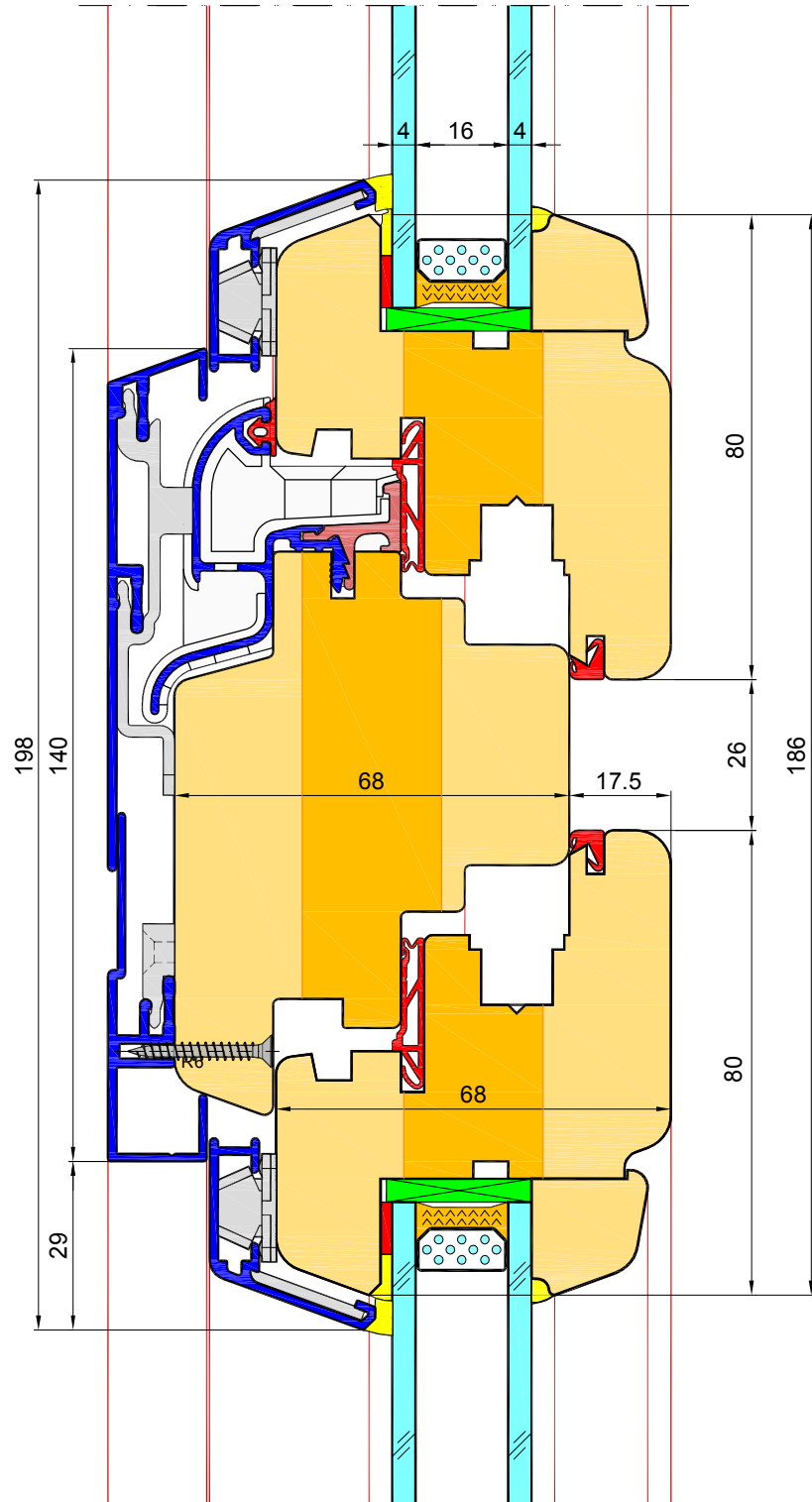



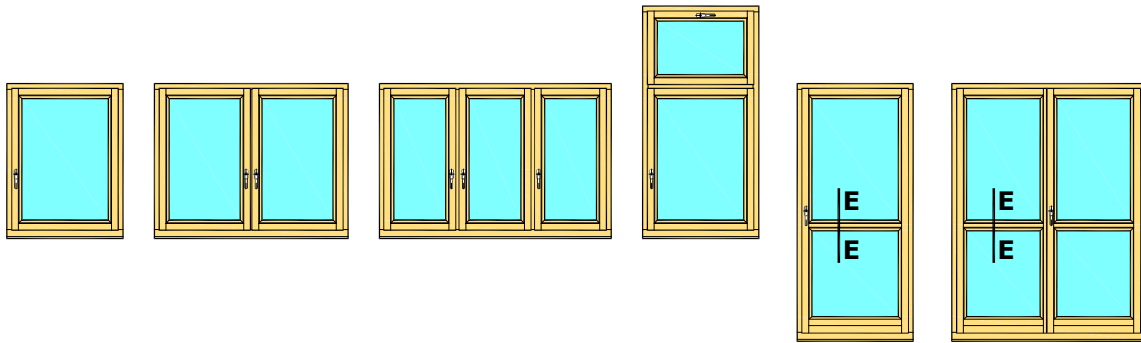

**E-E**

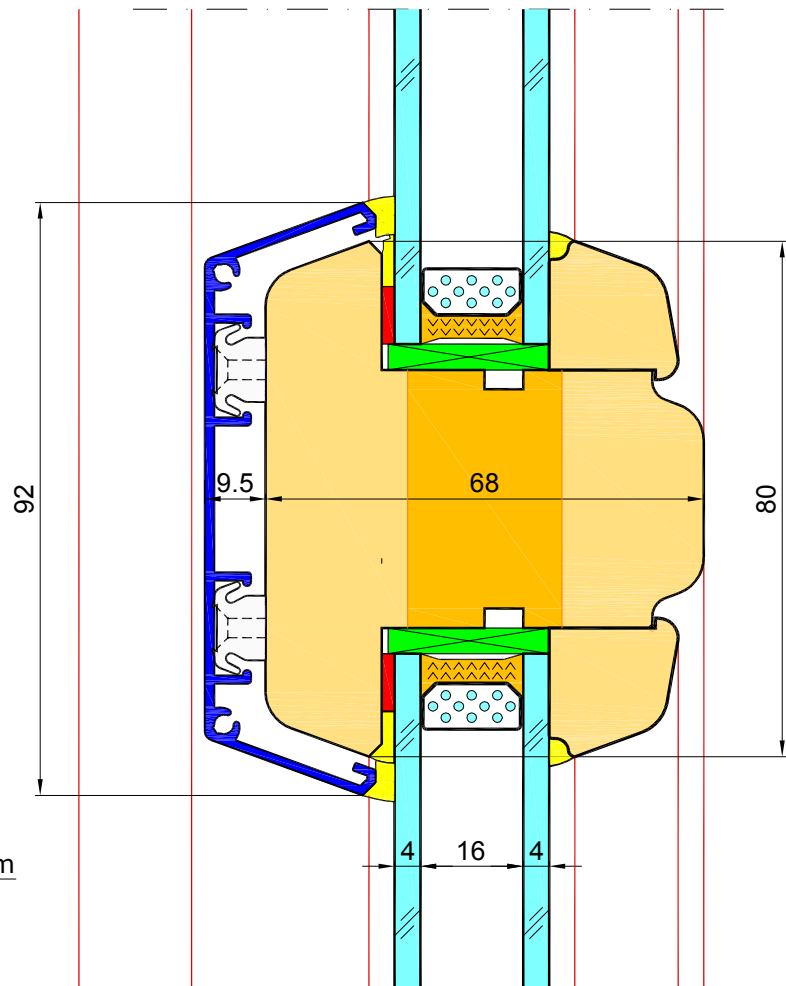

sash construction bar 80mm

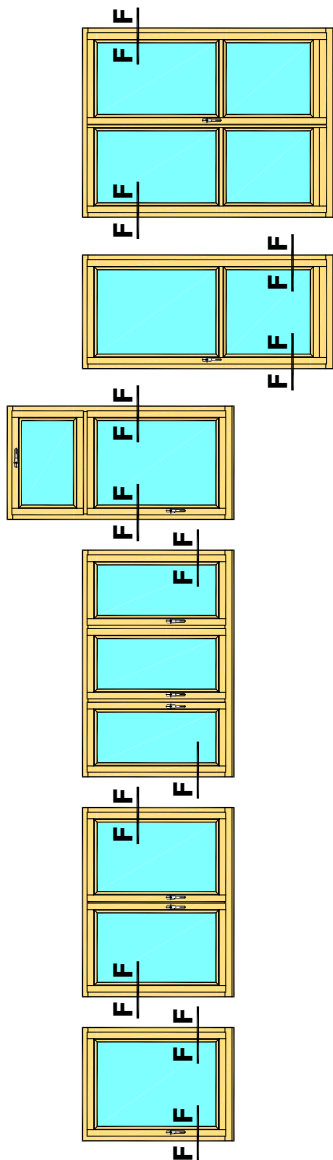

**F-F**

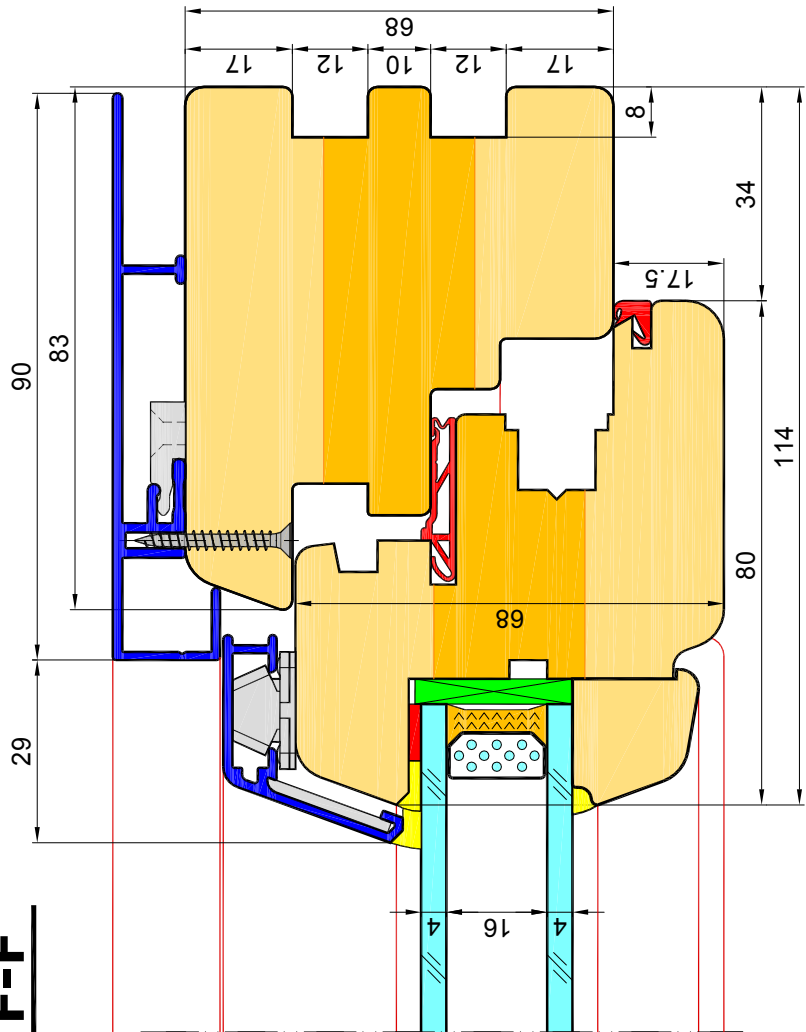

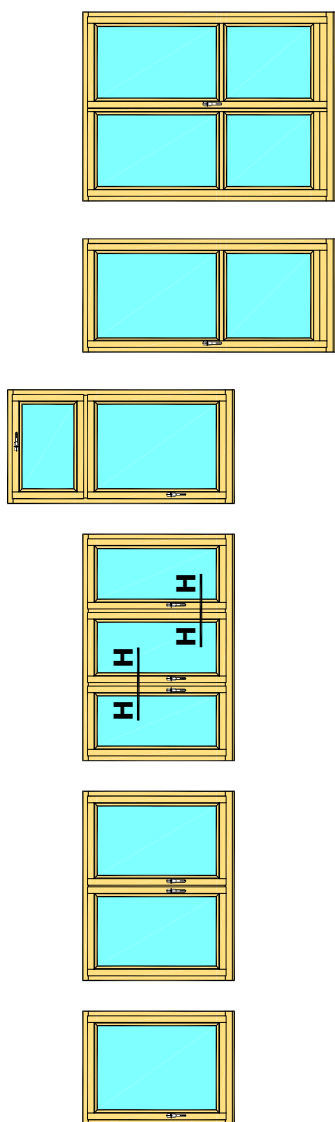

**H-H**

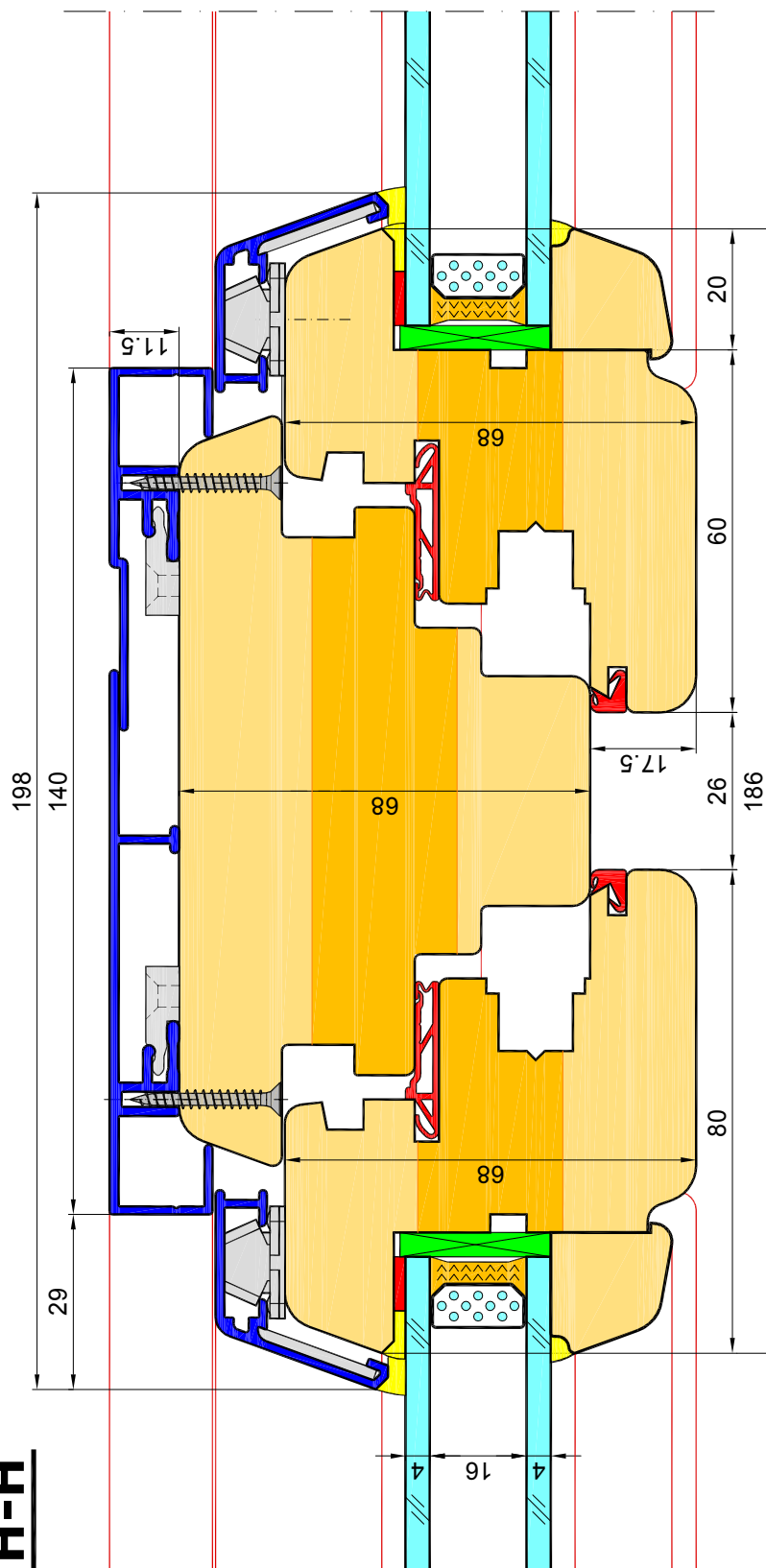

fixed mullion

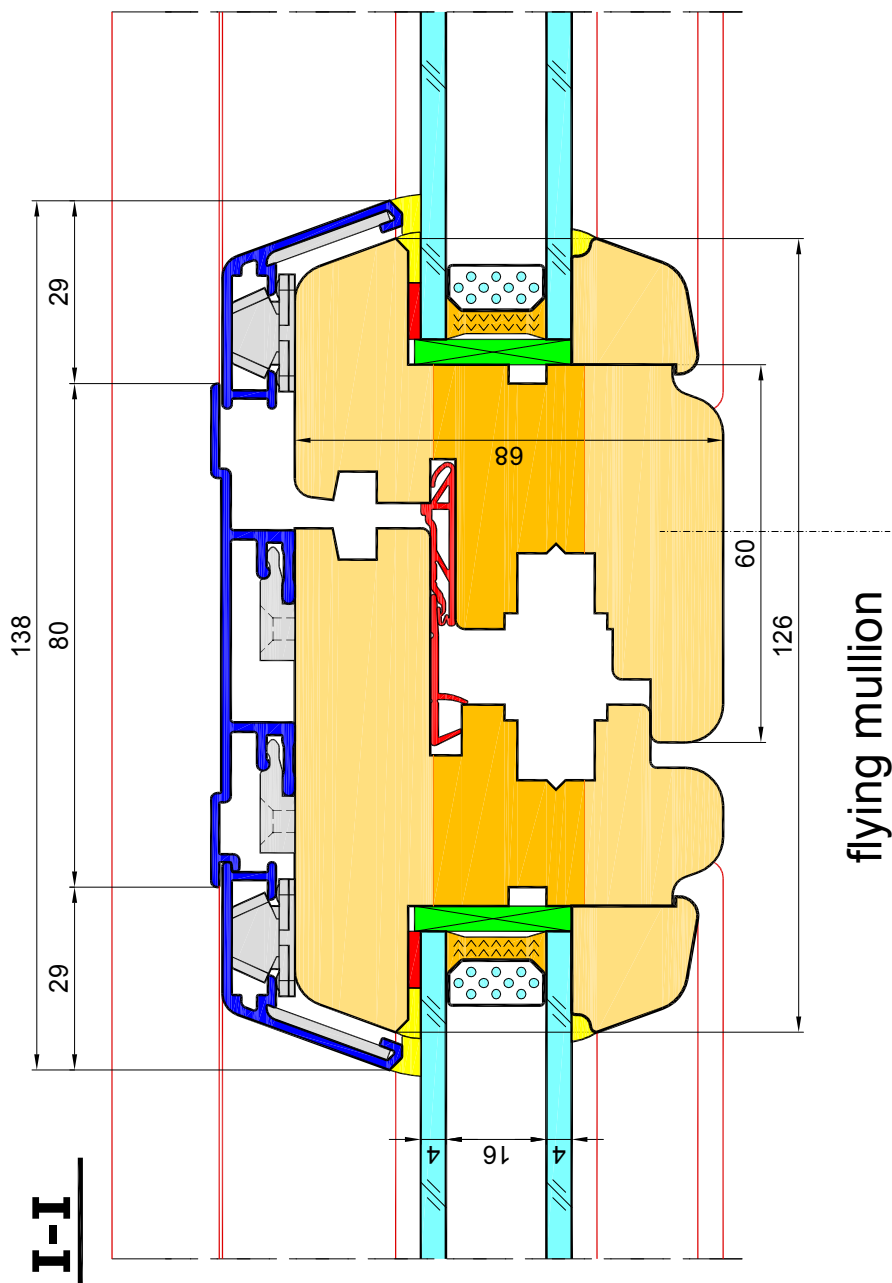
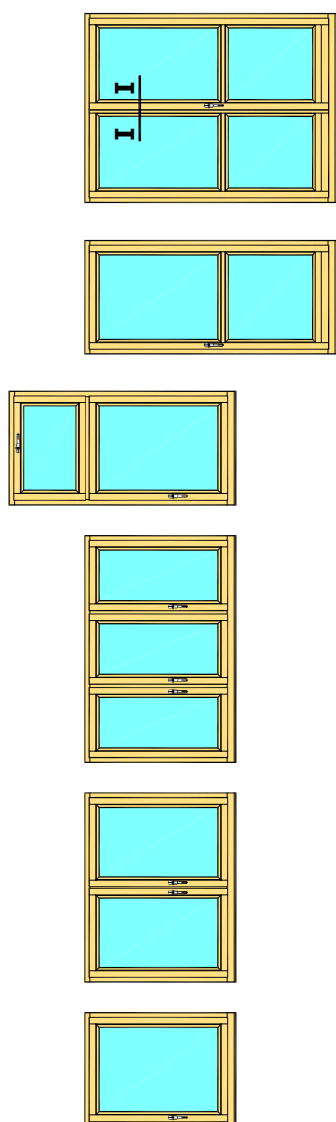

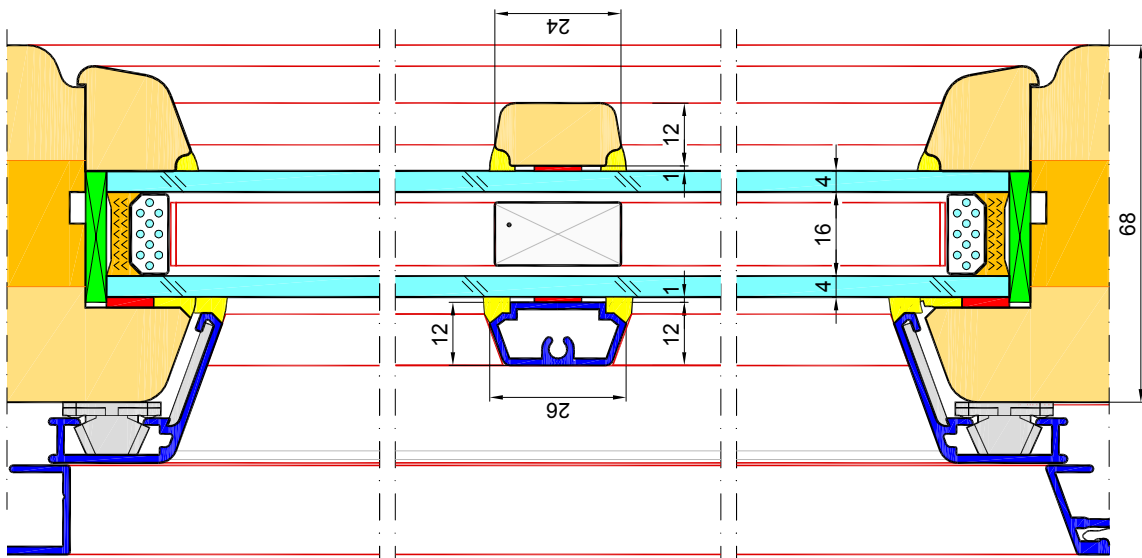
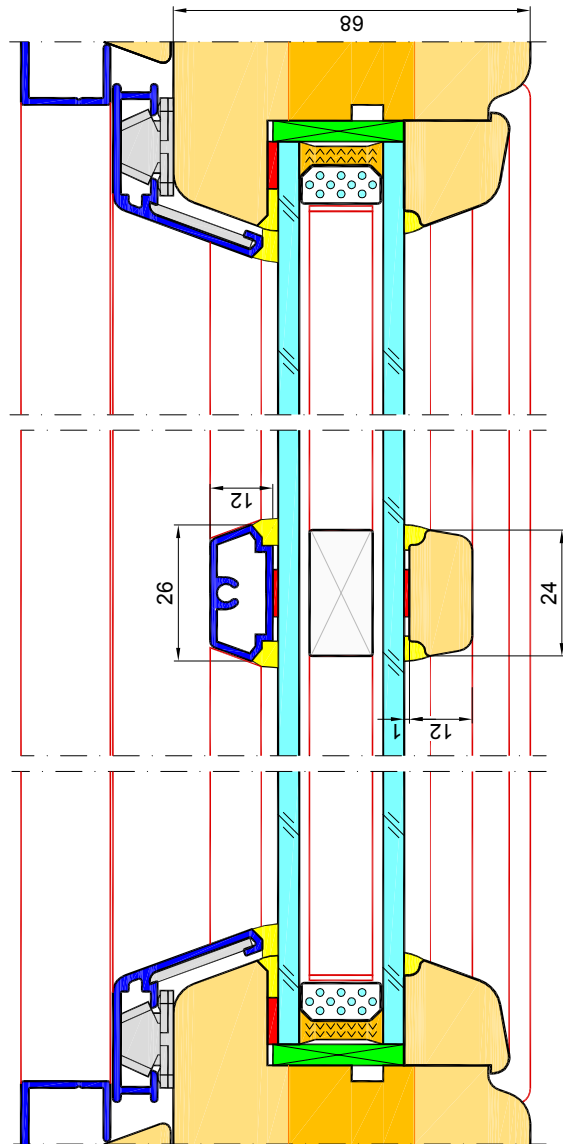
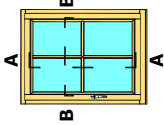
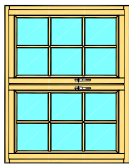
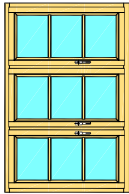
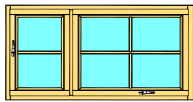
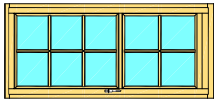
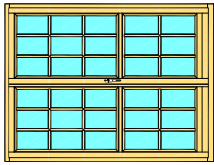
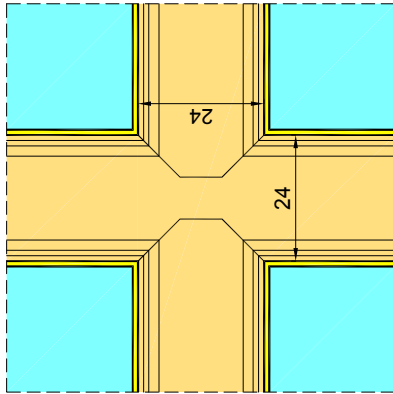

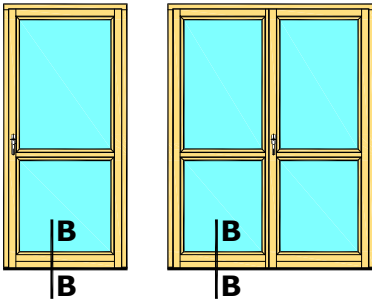

**B-B**

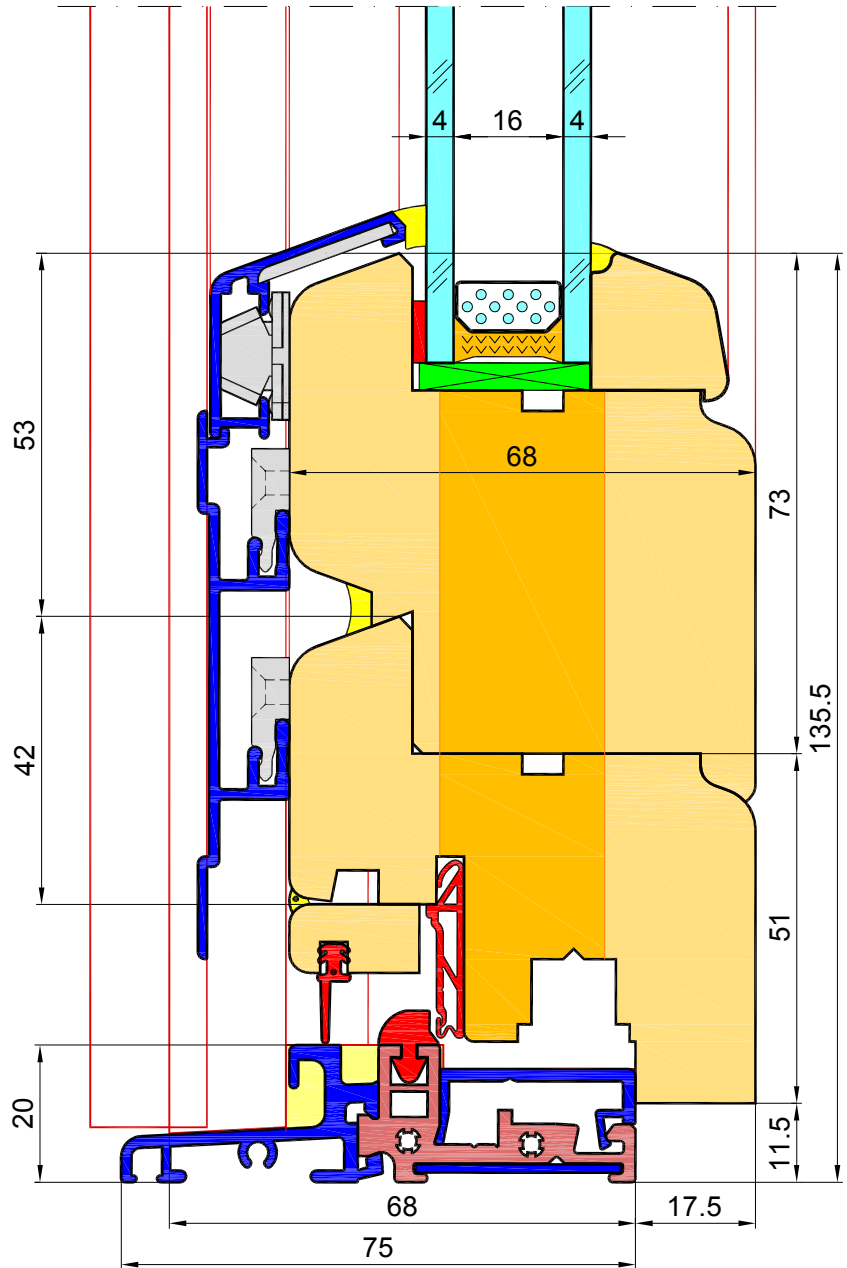

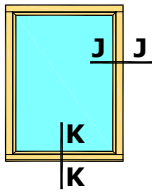

**K-K**

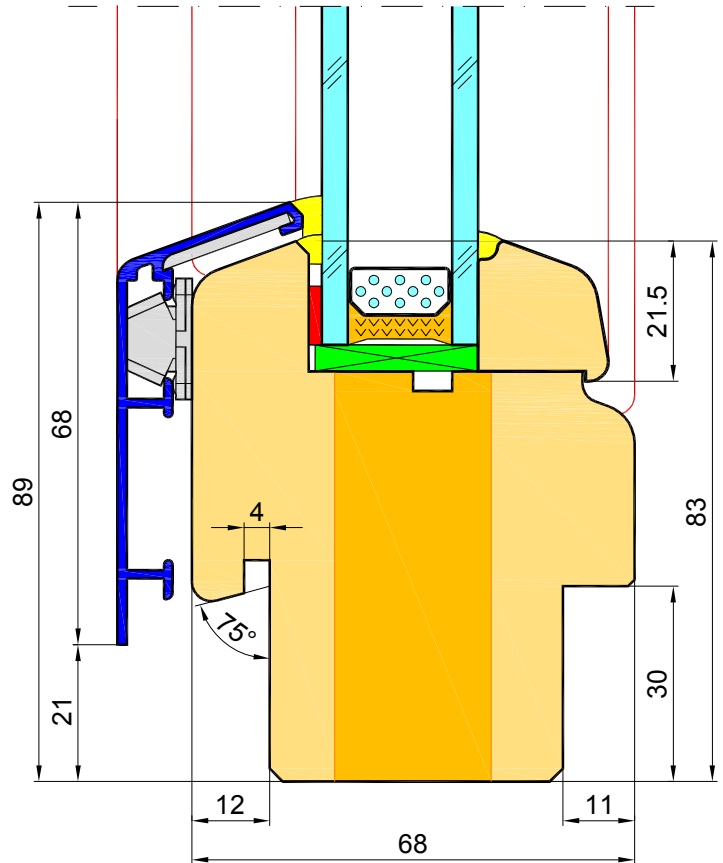

**J-J**

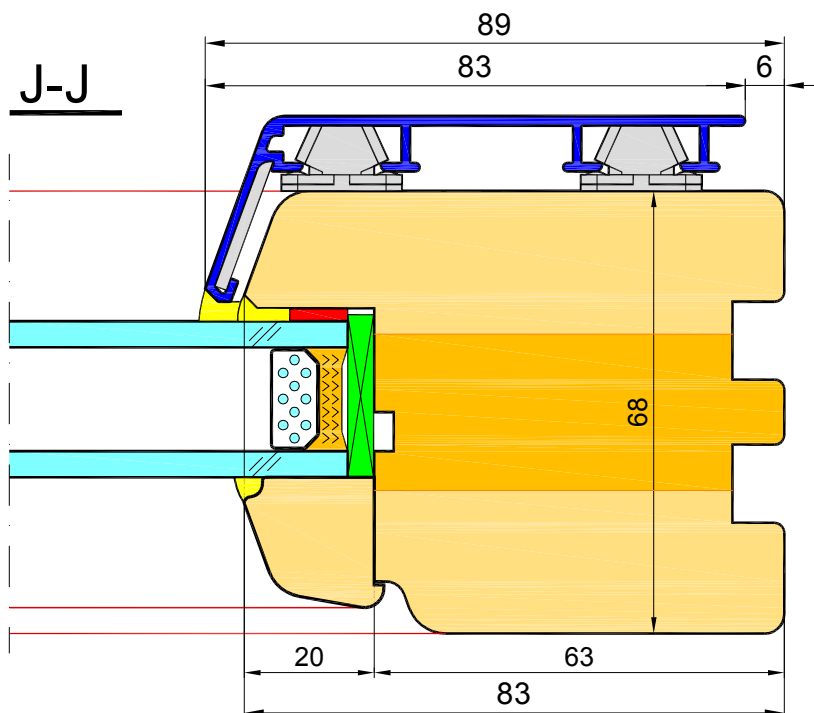

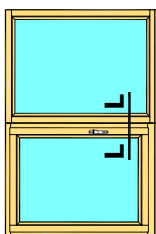
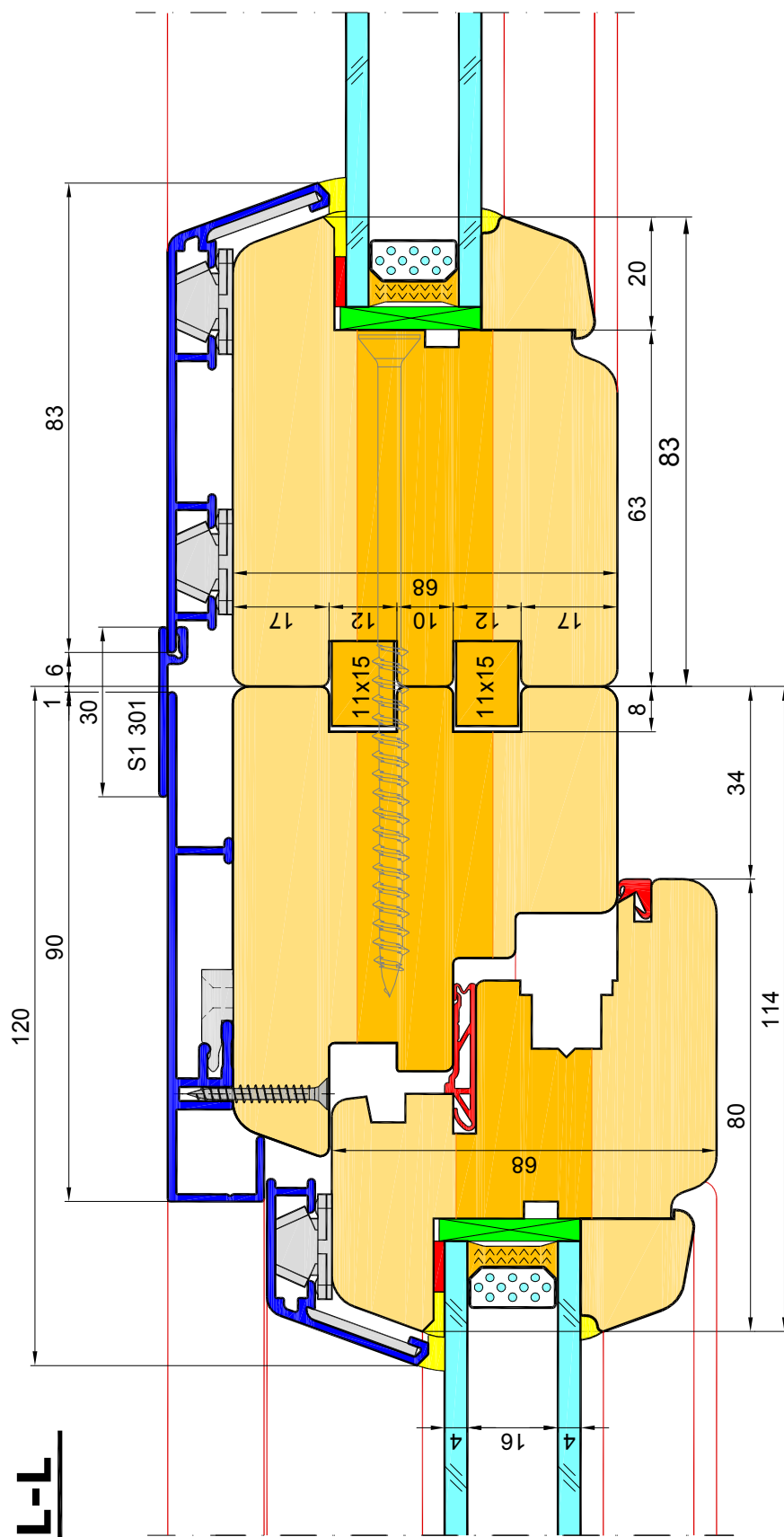

**L-L**



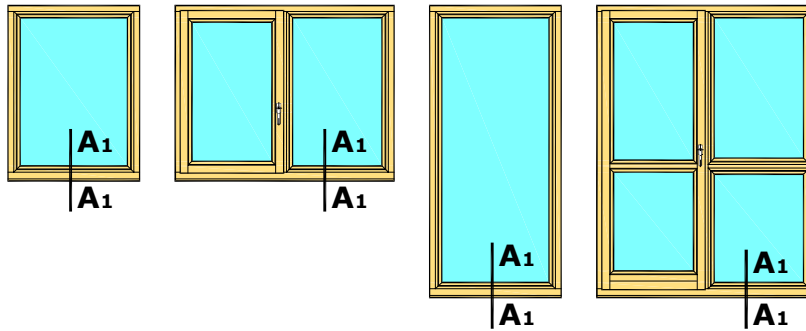

A1-A1

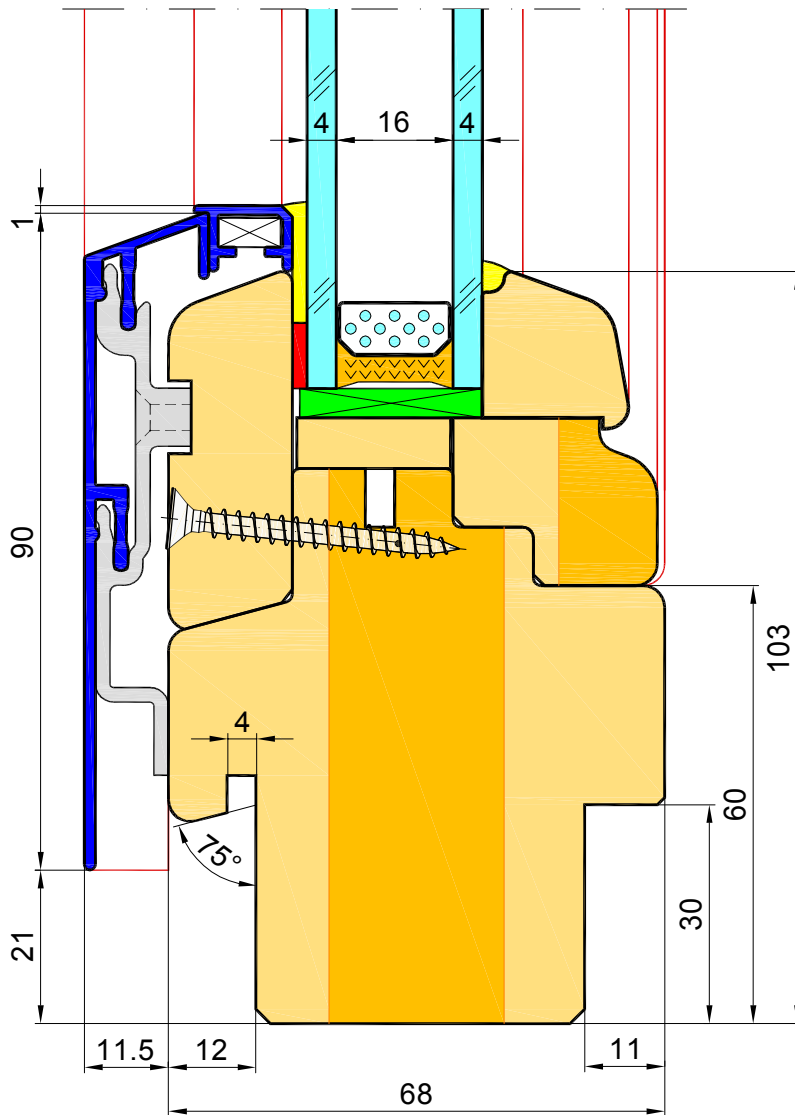

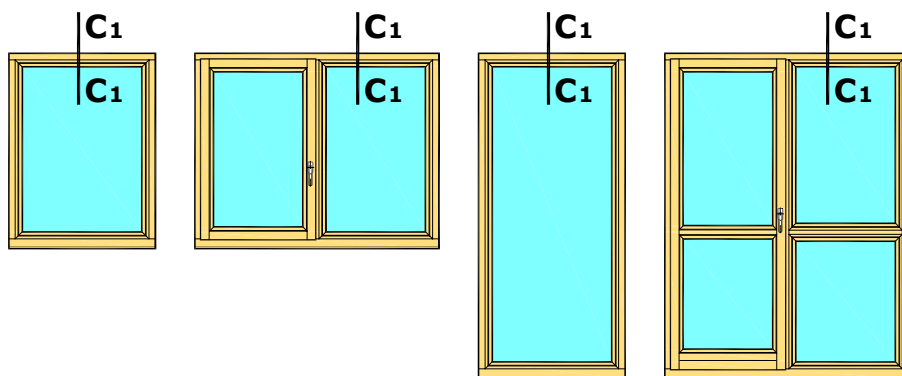

C1-C1

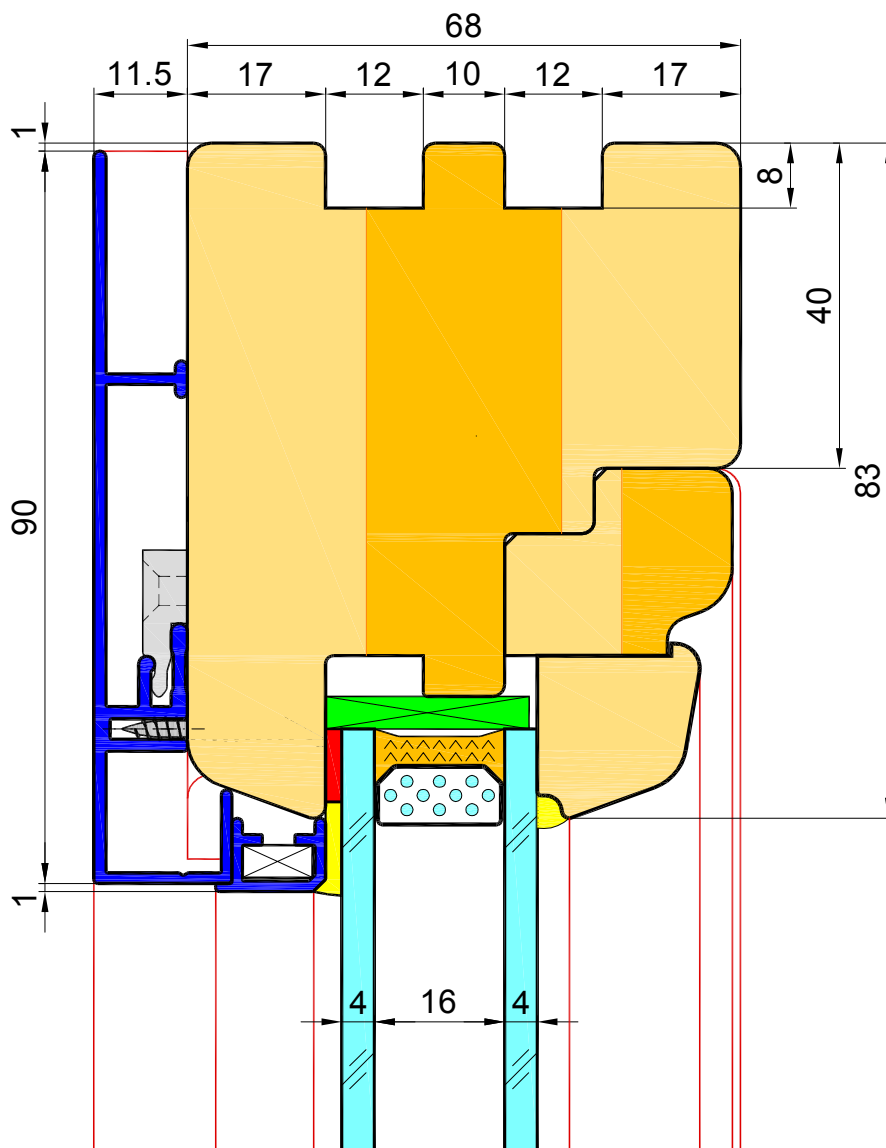

G1-G1

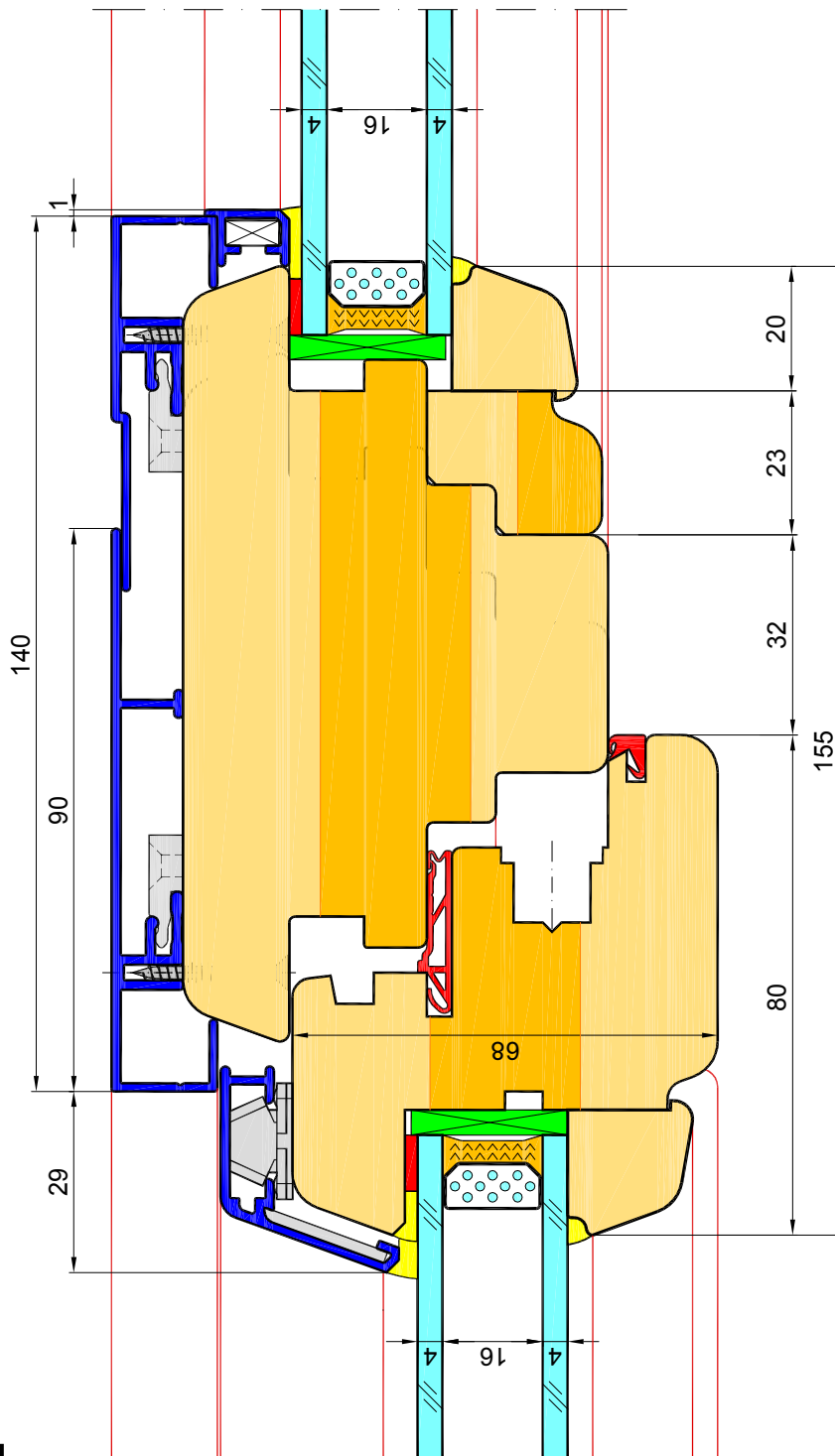
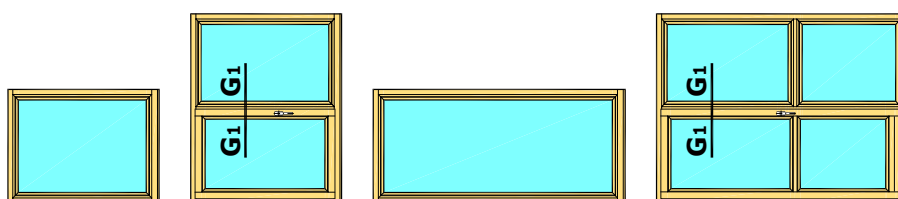

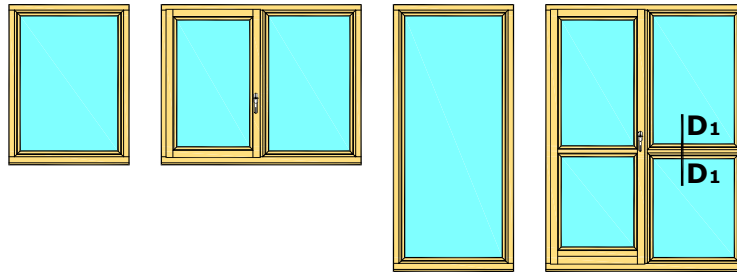

D1-D1



STYLE 68 ALU - tilt & slide terrace doors (PSK)

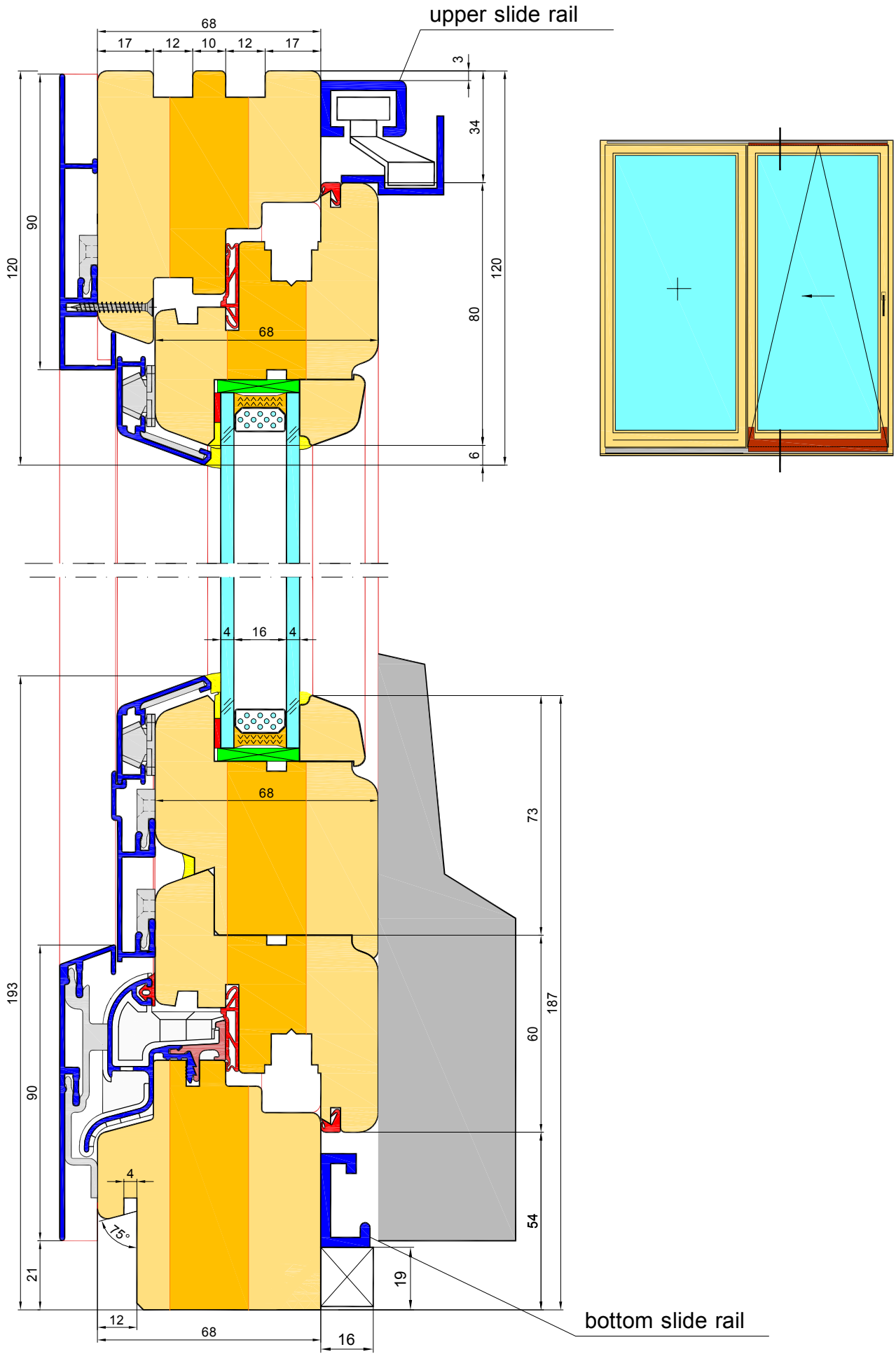

STYLE 68 ALU - Windows and balcony doors.  
\_ square glazing beads & sharp alu cladding.

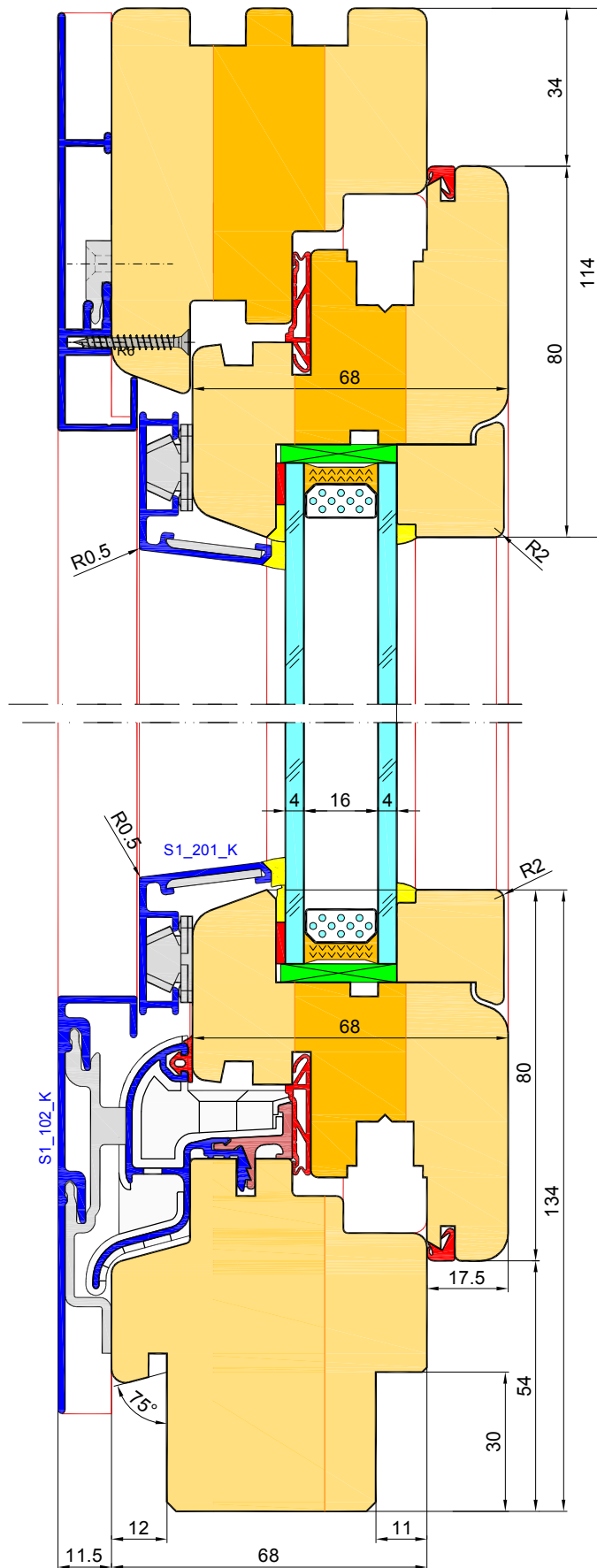

STYLE 68 ALU - triple glazing unit

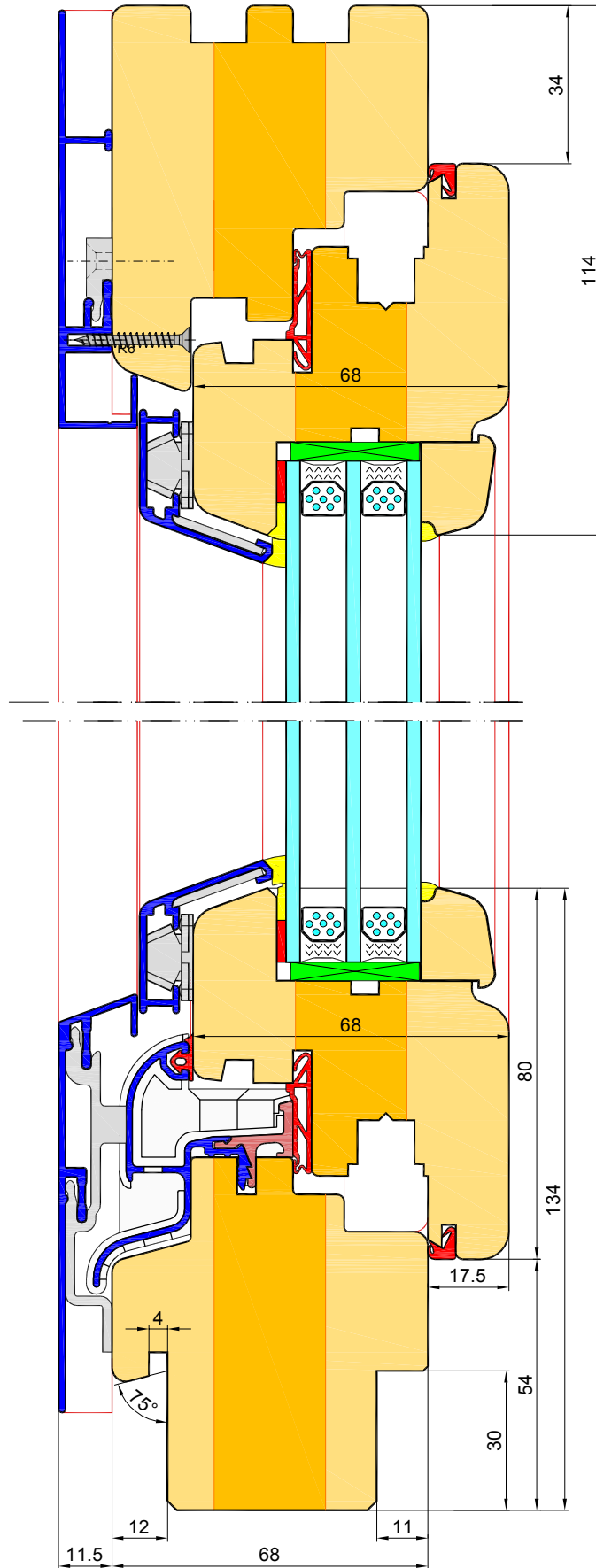

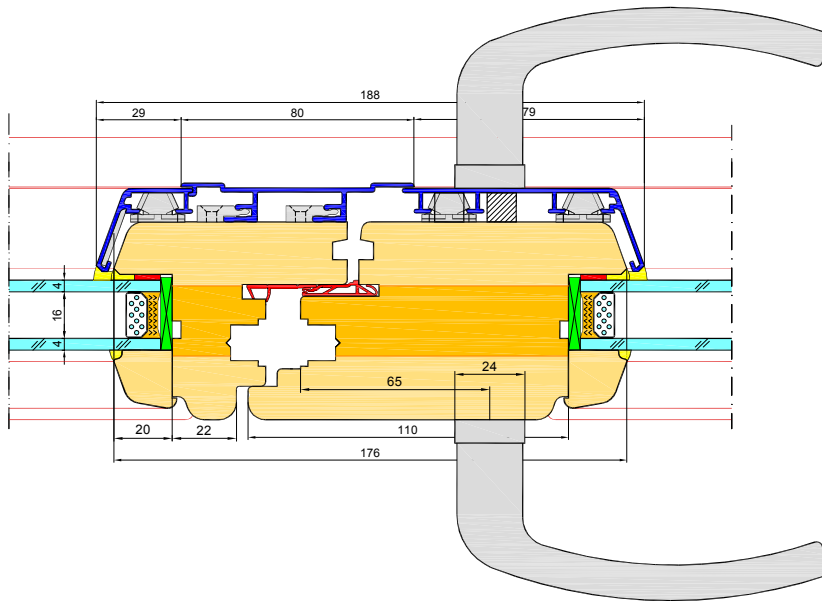

Double sash balcony doors with flying mullion

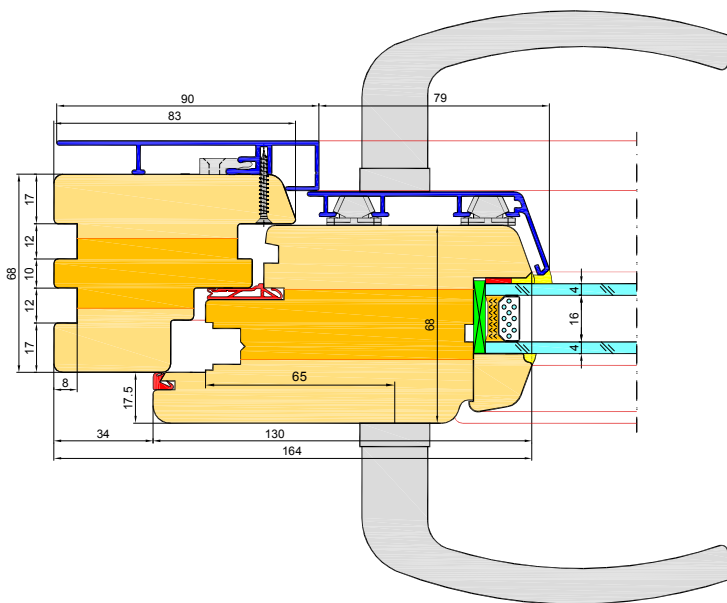

Single sash balcony doors

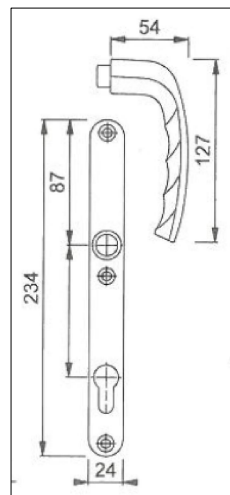



Corner connector 90°

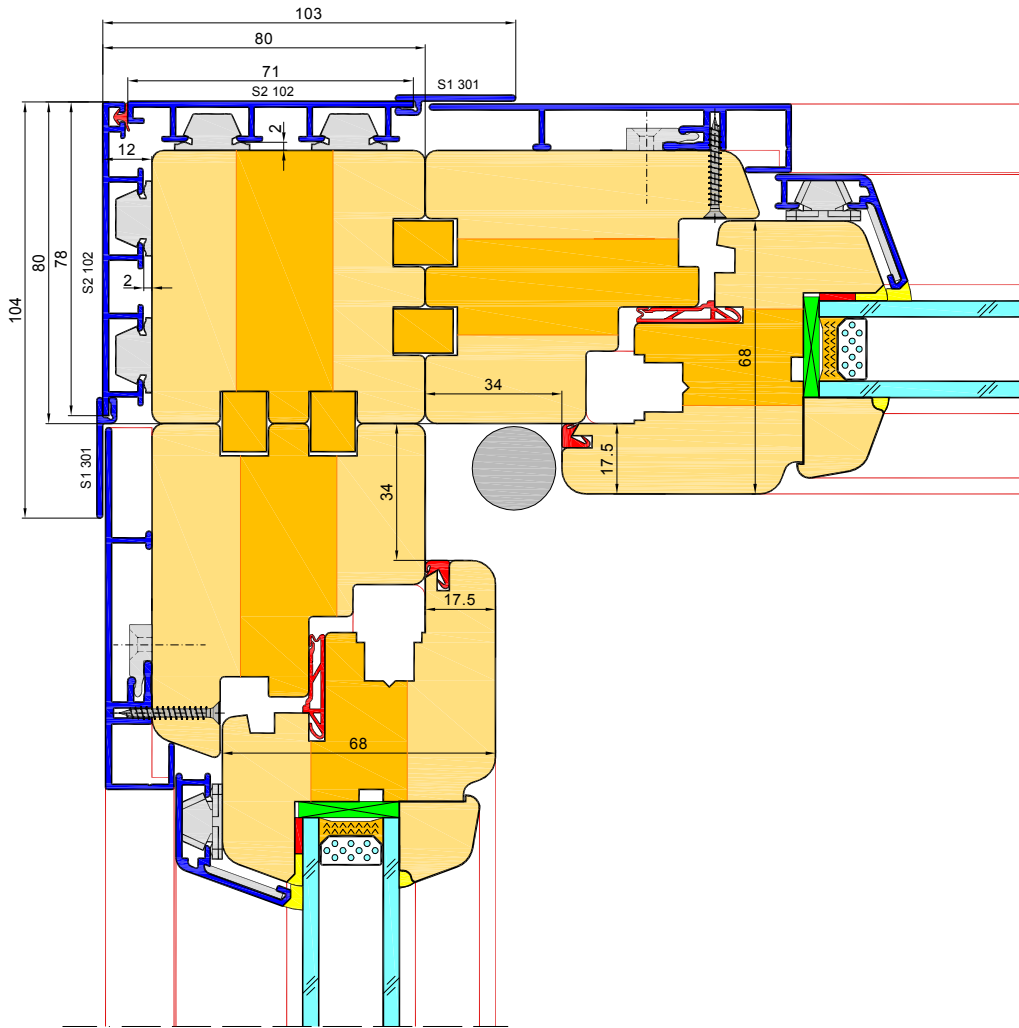

Corner connector 135°

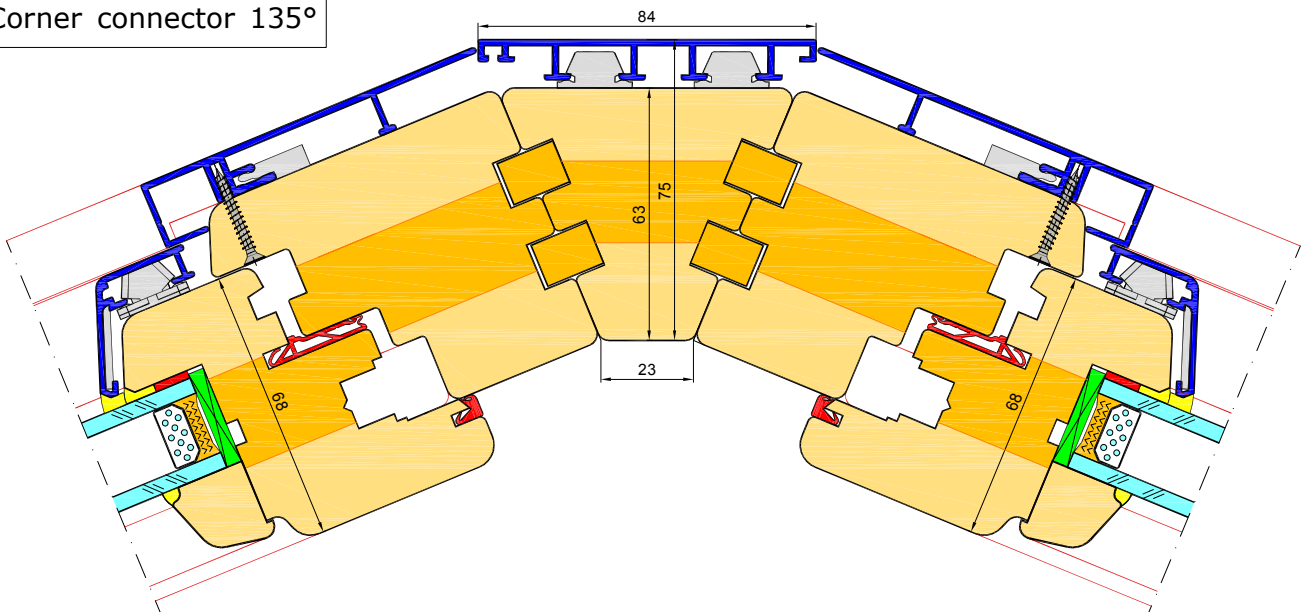

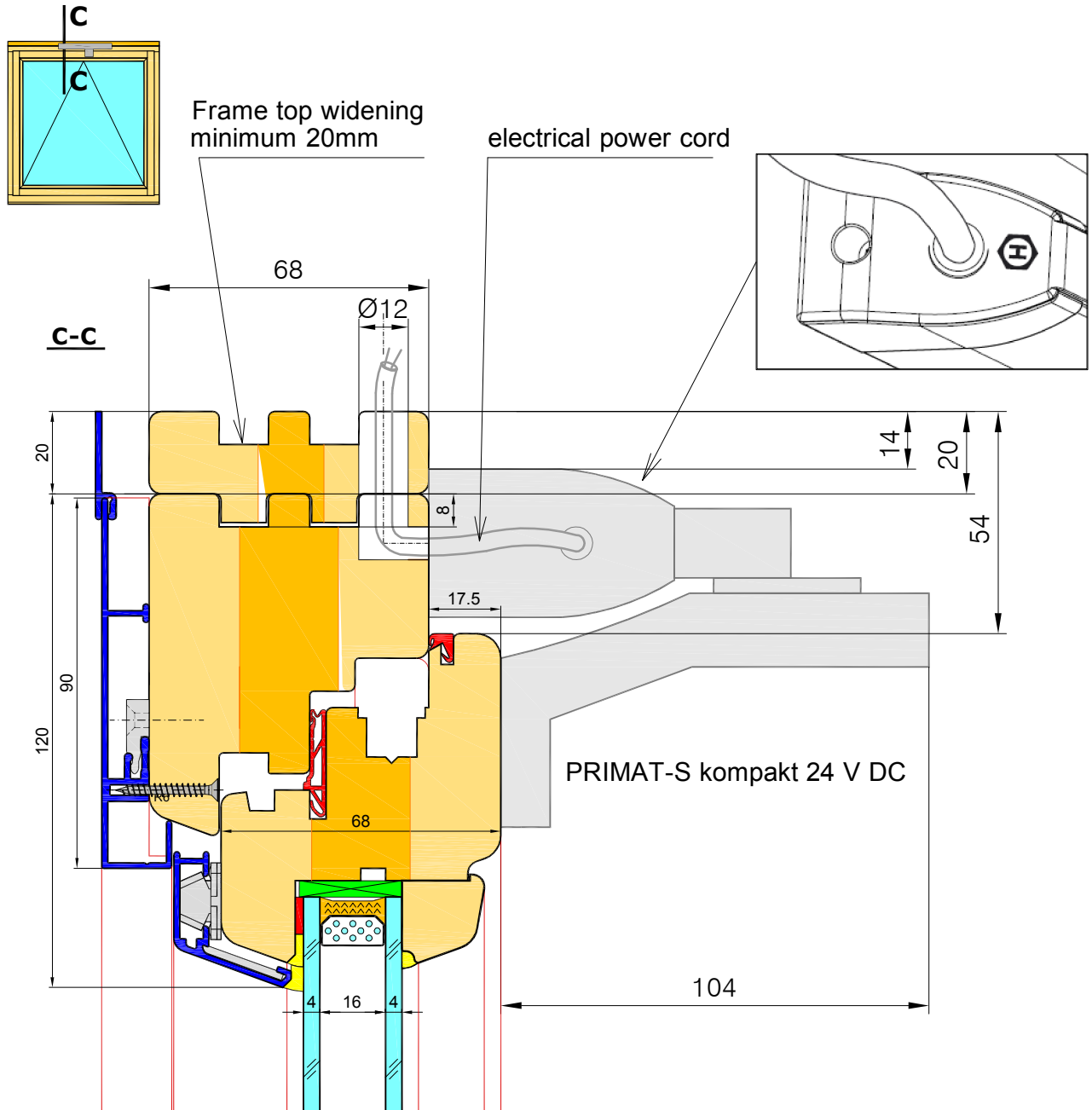

The window sash in the tilted position.

Maximum sash weight  
50kg

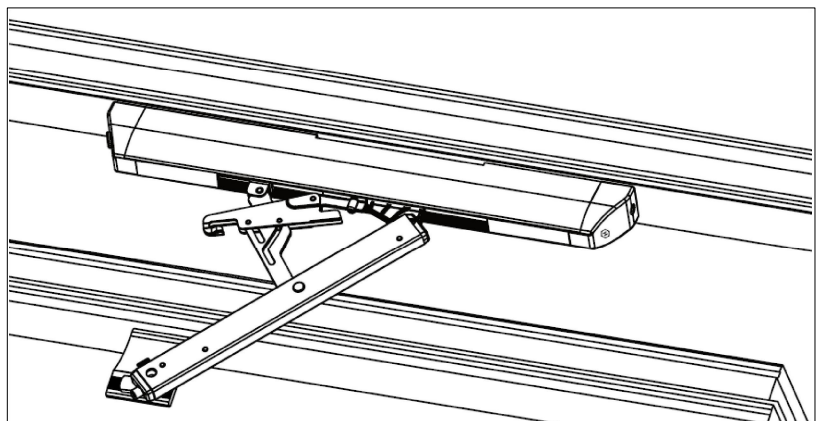

*Location of the EMM vent in the window cross section.*

