

ECO LINE ALU - Sliding door

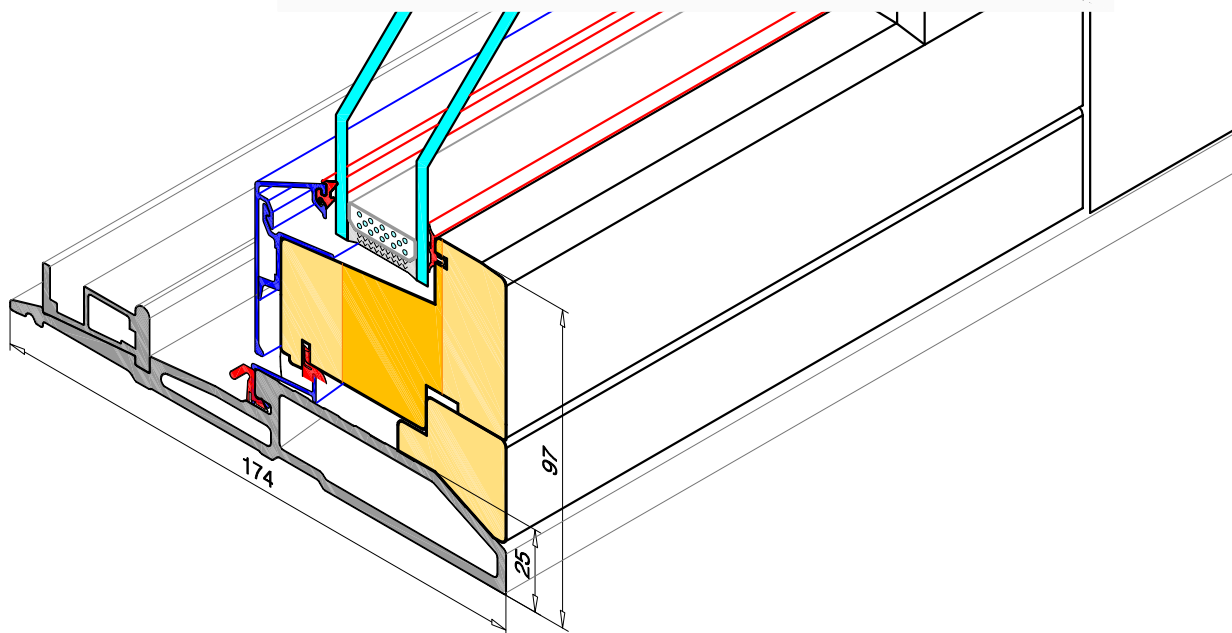

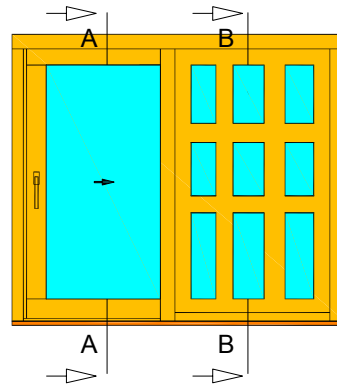

ECO LINE ALU _ glazing: 44mm

A-A B-B

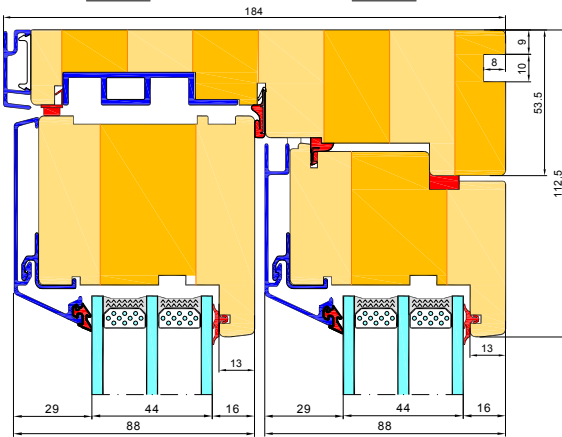

ECO LINE ALU _ glazing: 32 mm

A-A B-B

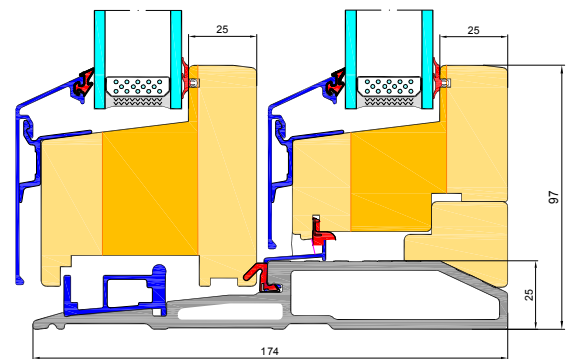
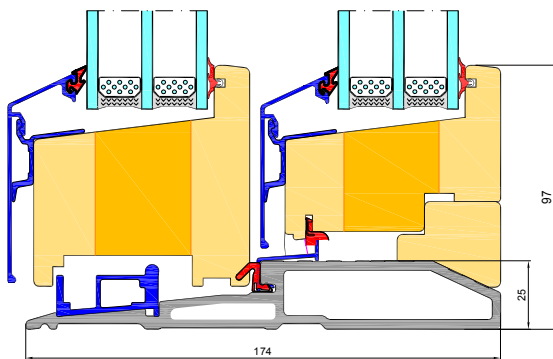
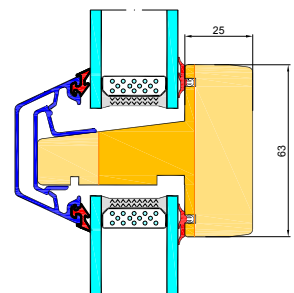
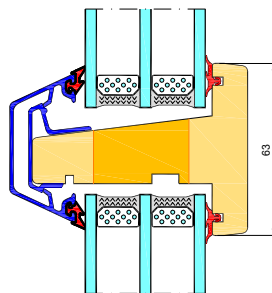
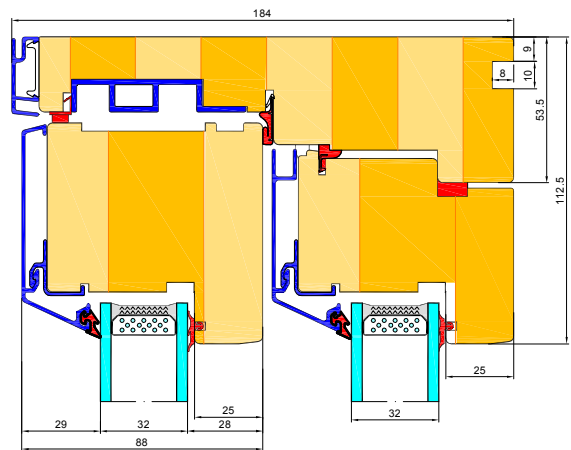

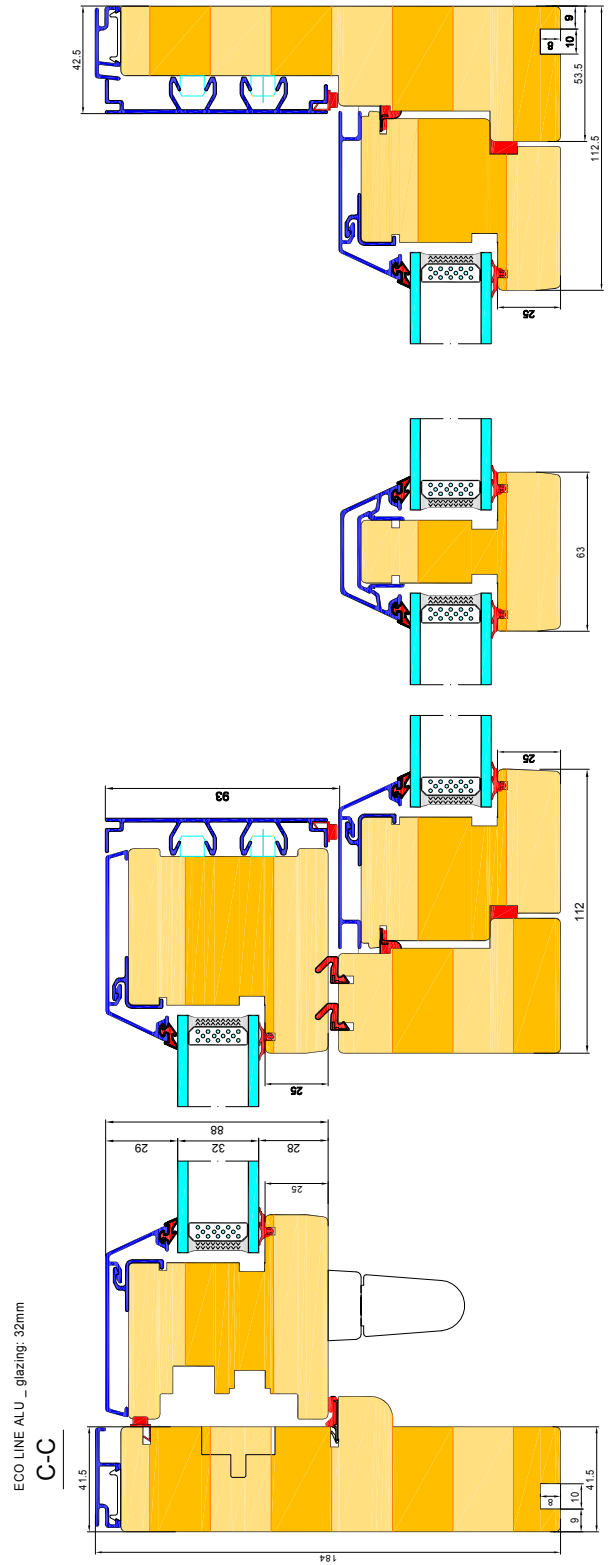
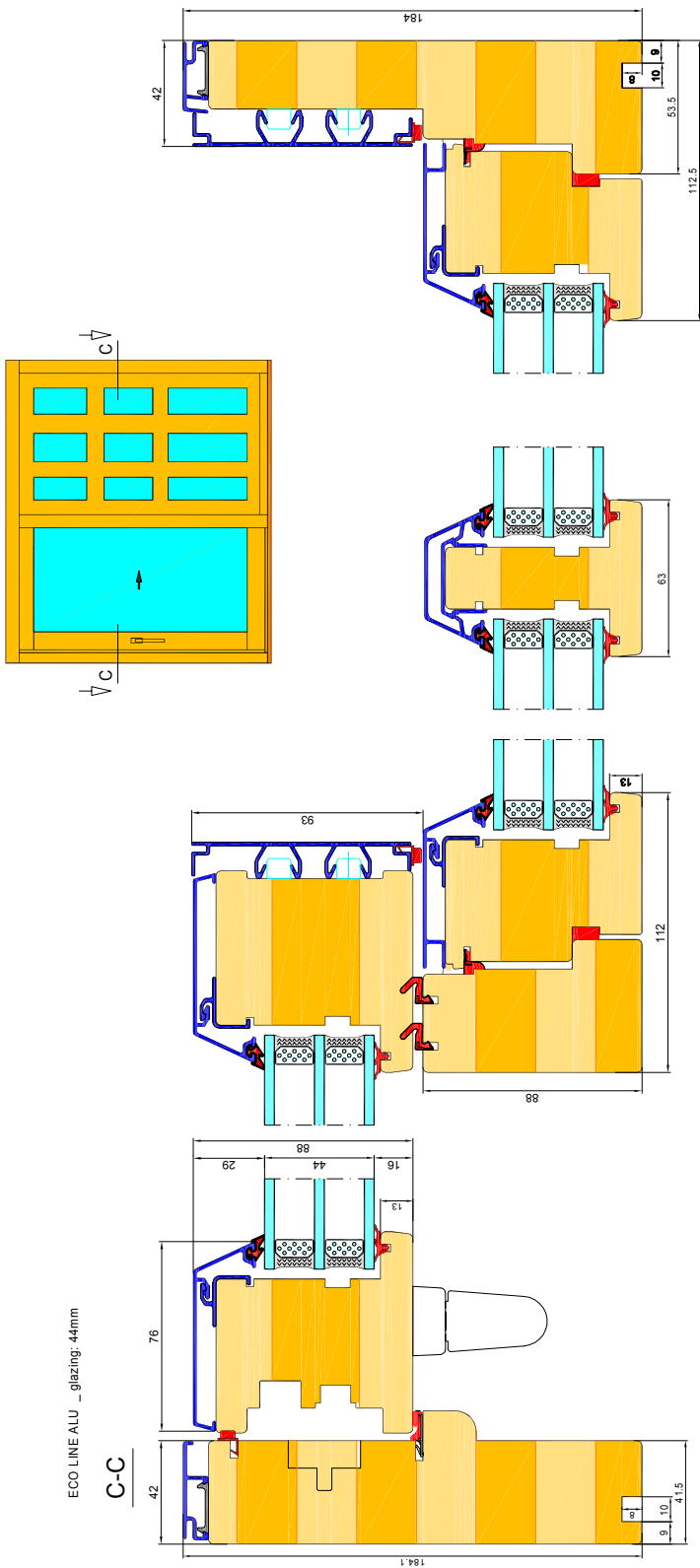

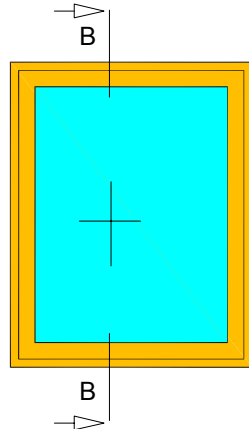

ECO LINE ALU _ glazing: 44; 32 mm

B-B

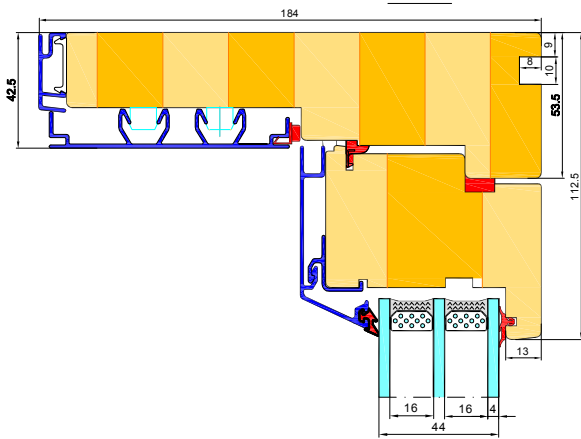

B-B

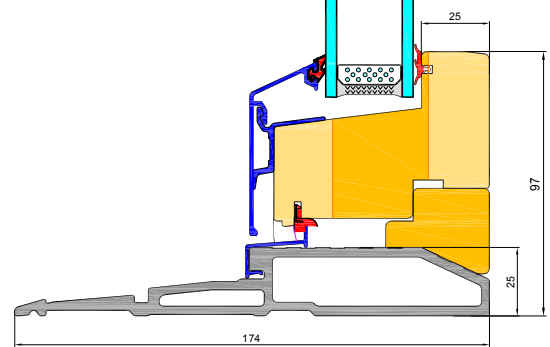
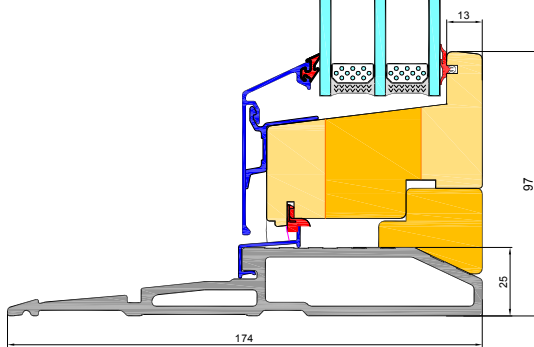
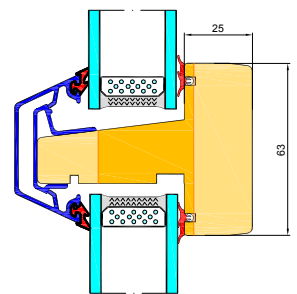
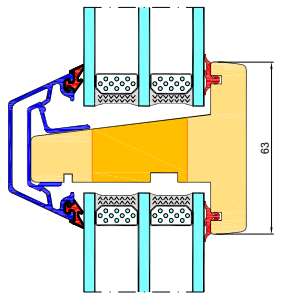
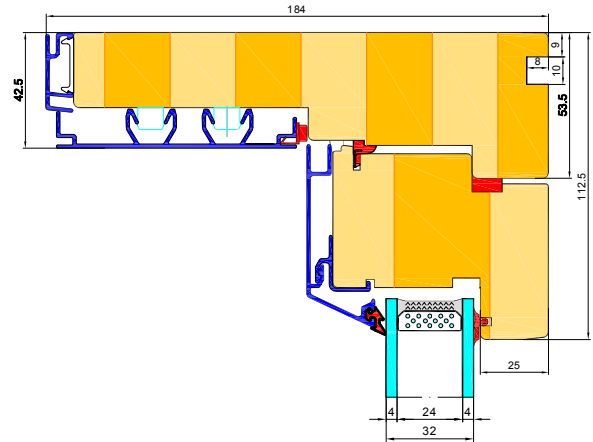

ECO LINE ALU _ glazing - 44mm

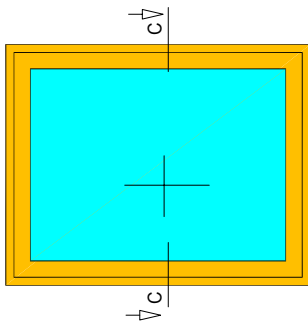

C-C

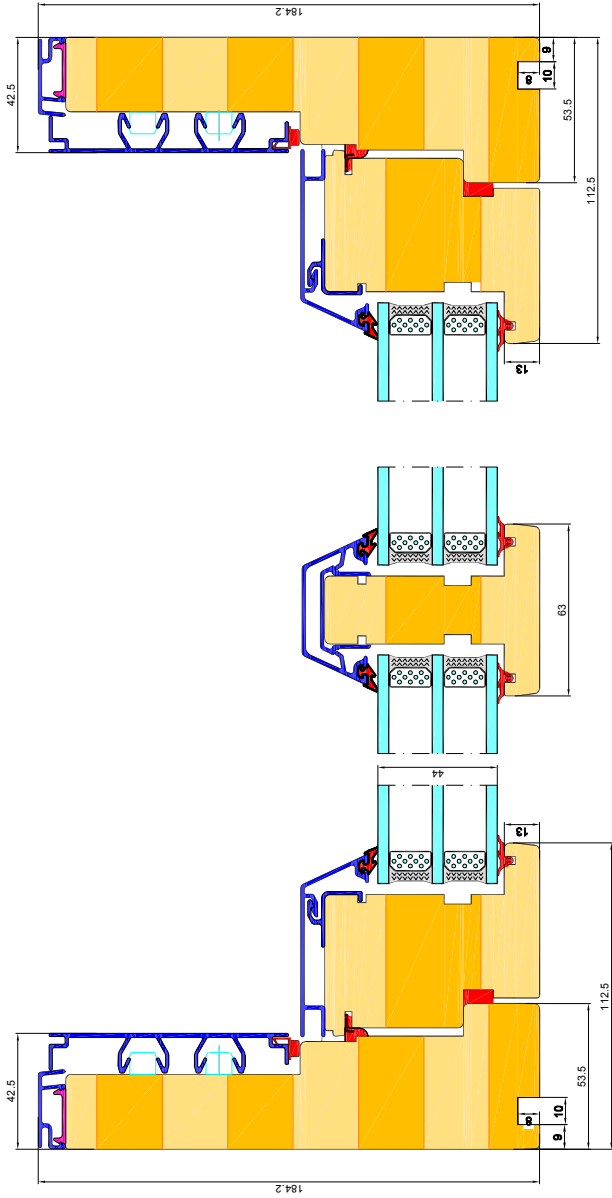

C-C

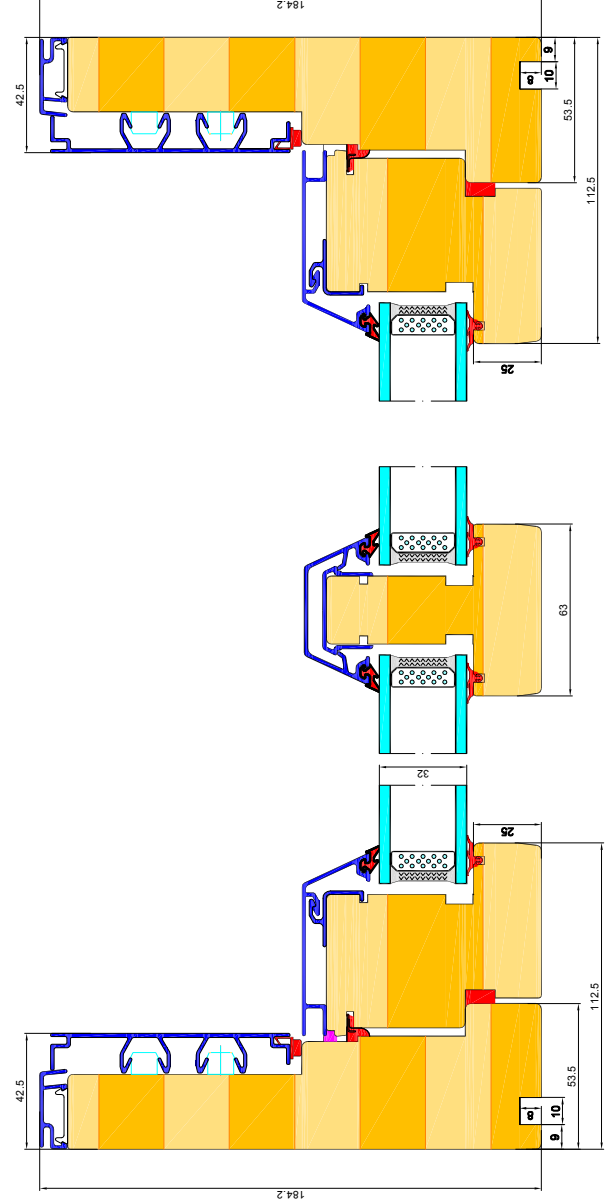

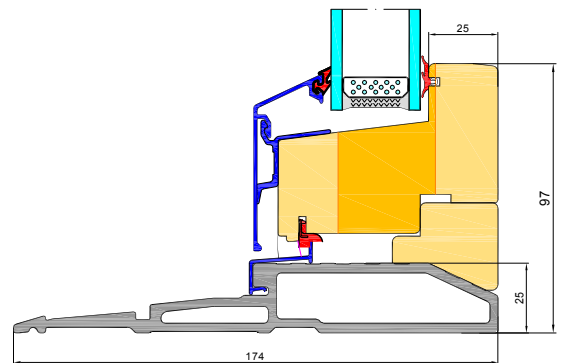
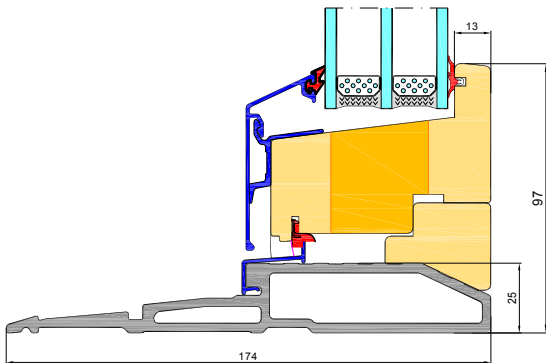
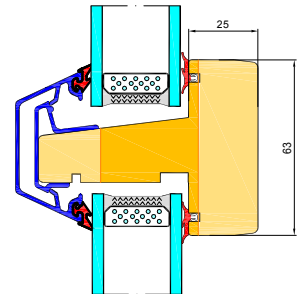
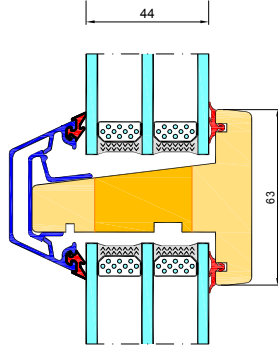
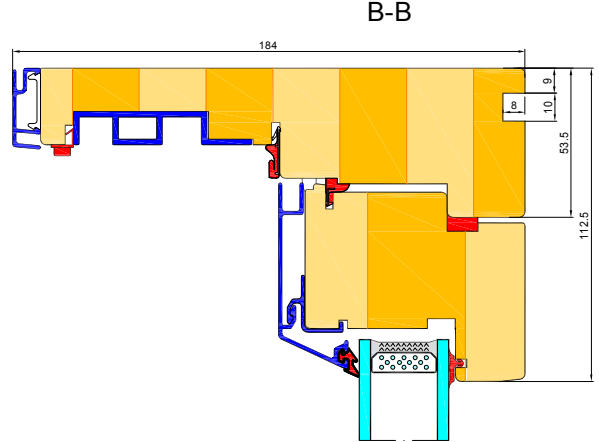
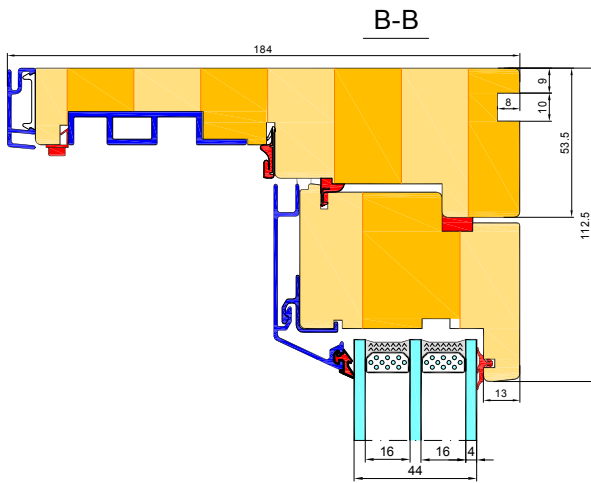
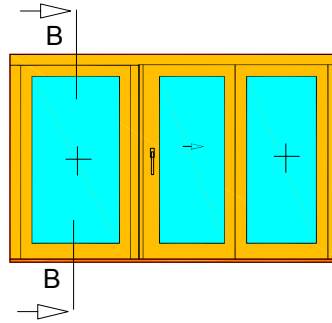

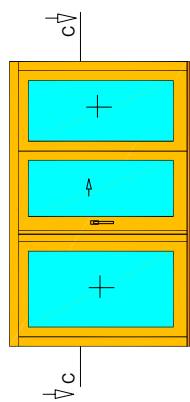

Schemat G-2

ECO LINE ALU _ glazing: 44mm

C-C

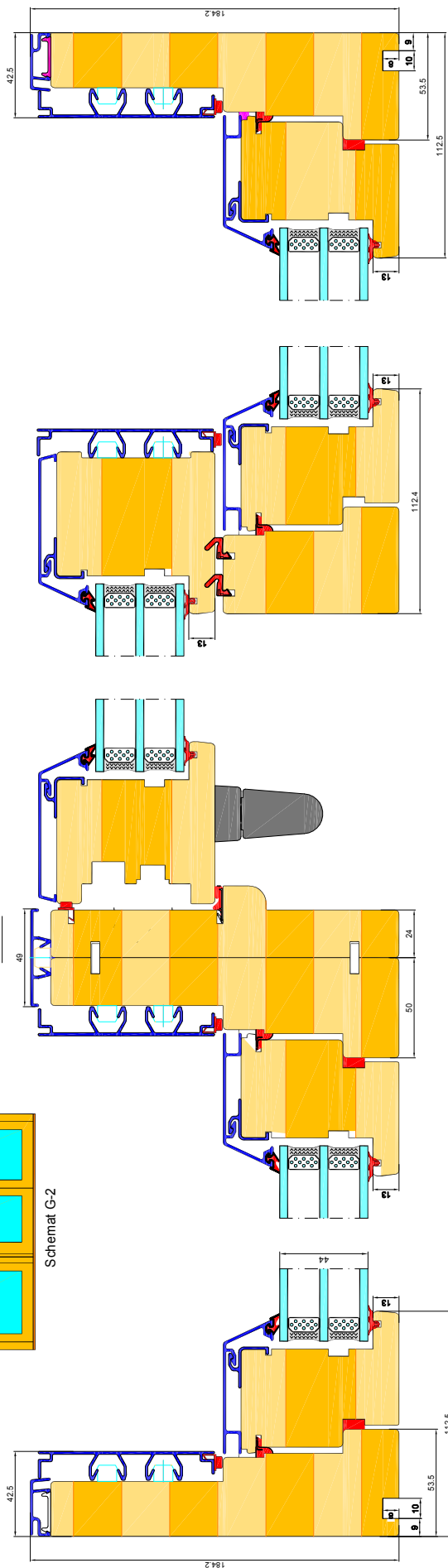

ECO LINE ALU _ glazing: 32mm

C-C

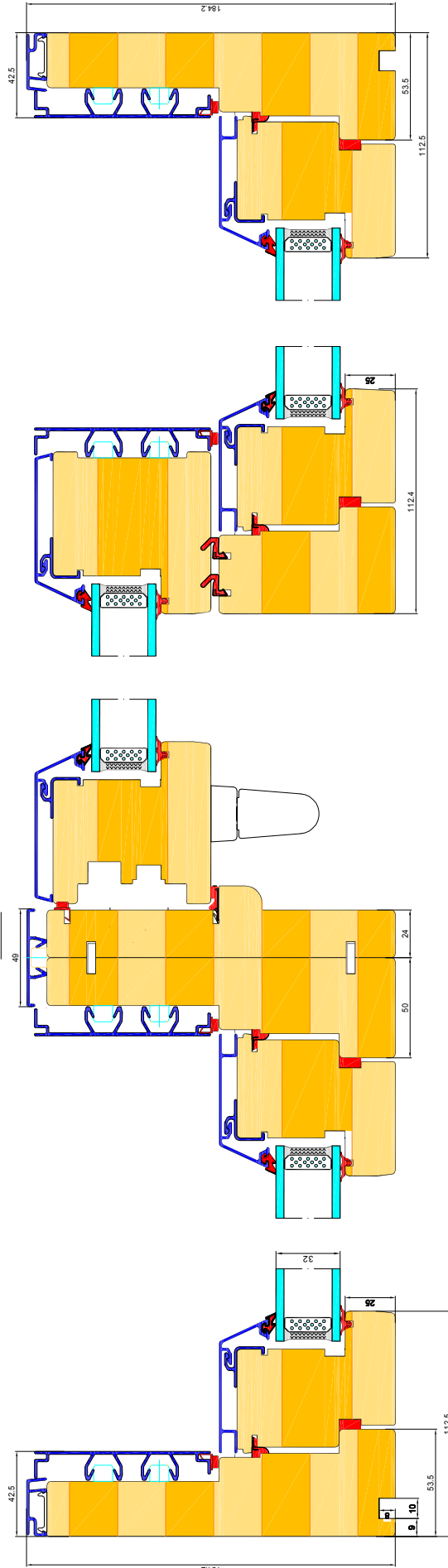

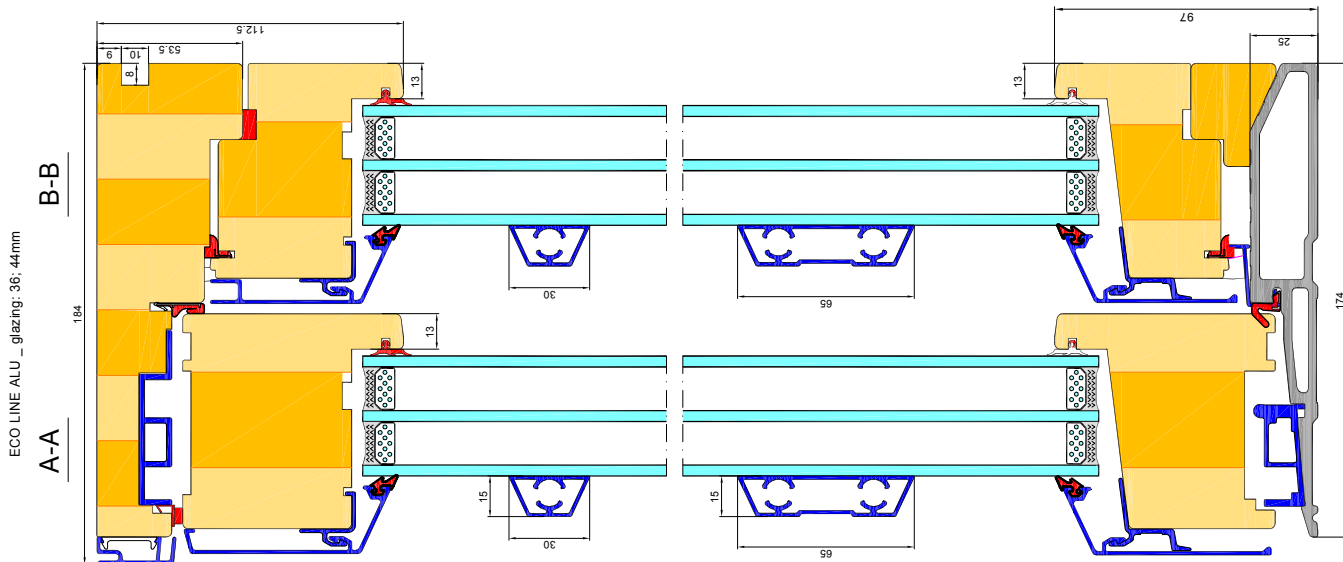
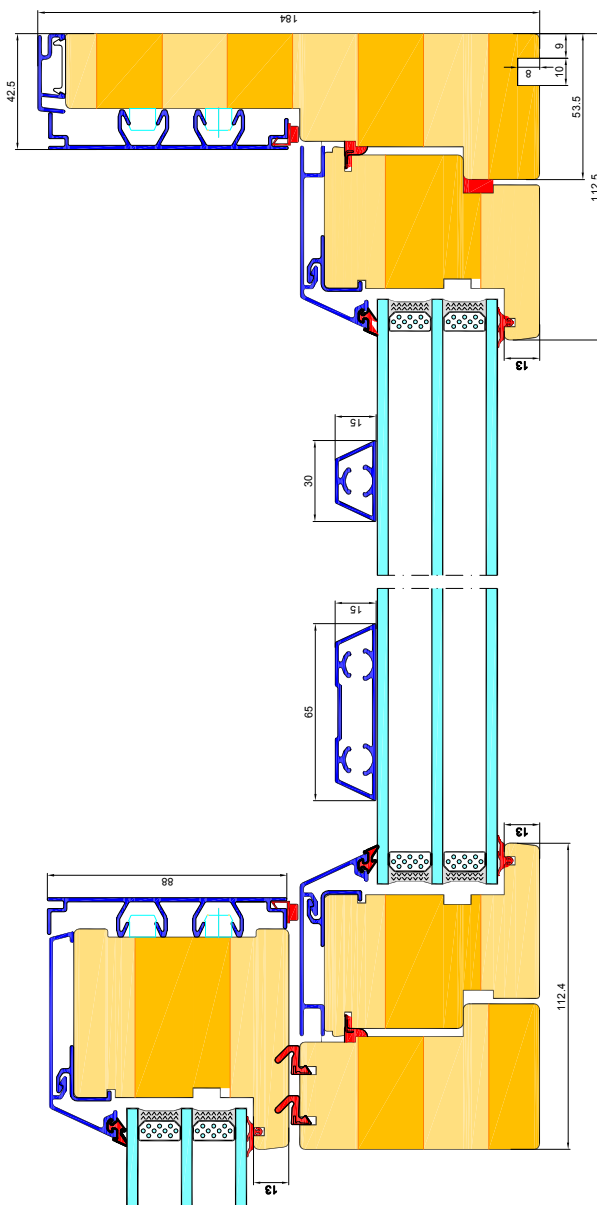
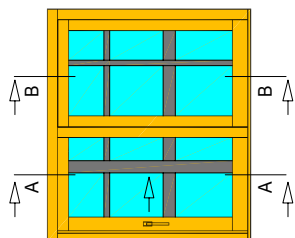

ECO LINE ALU _ glazing: 36; 44mm